

Butterfly valve accessories

Stainless steel lever handle for butterfly valves Ø25 to Ø76

Model 61324 stainless steel lever with plastic handle

Model 61347 stainless steel lever and handle



Specifications

Dimensions: DN25 to DN76 (1" to 3")

Ambient temperature: +90°C max.

Material: Stainless steel / plastic

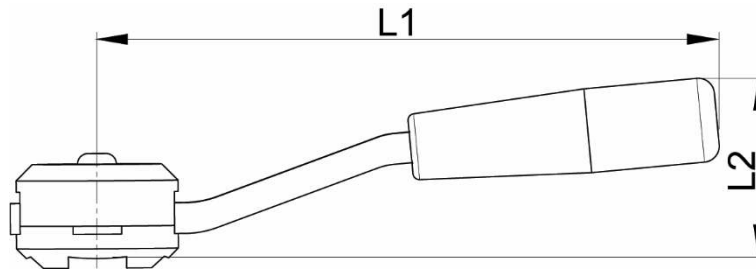

Valve DN (mm)	Valve NB (inches)	L1 (mm)	L2 (mm)	Valve shaft (mm)	Weight (kg)	Part number
25 to 76	1" to 3"	195	52	8 (f lat side)	0.60	261324-2576
25 to 76	1" to 3"	195	52	8 (f lat side)	0.80	261347-2576

2-position handle: open/closed

You must drill a hole in the butterfly valve's shaft to be able to insert the pin that is needed for handle assembly.

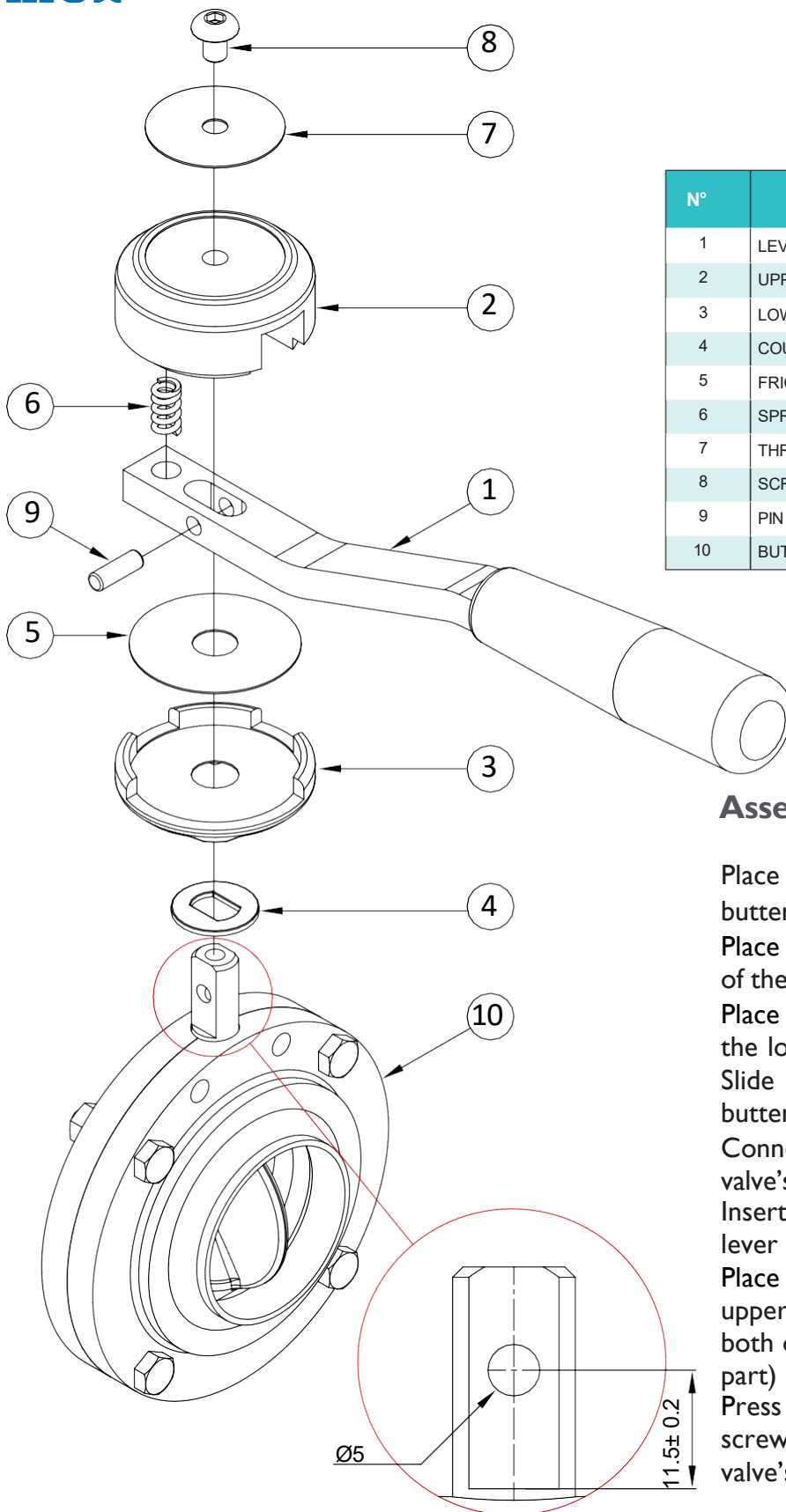

N°	Part Name	Material	Quantity
1	LEVER (HANDLE PART)	SS	1
2	UPPER PART	A2 SS	1
3	LOWER PART	SS	1
4	COUPLING WASHER	SS	1
5	FRICTION WASHER	PTFE	1
6	SPRING	SS	1
7	THRUST WASHER	SS	1
8	SCREW	SS	1
9	PIN	SS	1
10	BUTTERFLY VALVE	SS	1

Assembly

Place the coupling washer **4** onto the butterfly valve's shaft **10**.

Place the lower part of the lever **3** on top of the coupling washer **4**.

Place the friction washer **5** in the lower part of the lever **3**.

Slide the lever (handle part) **1** onto the butterfly valve's shaft **10**.

Connect the lever **1** and the butterfly valve's shaft **10** with the pin **9**.

Insert the spring **6** into the recess in the lever (handle part) **1**.

Place the thrust washer **7** on top of the upper part of the lever **2**, then place both of these parts onto the lever (handle part) **1**.

Press on the upper part of the lever **2** to screw the screw **8** into the butterfly valve's shaft **10**.

Shaft drilling required
Standard non-drilled valve provided