

Butterfly valve accessories

Multi-position handle with trigger for butterfly valves Ø25 to Ø76

Model 61343 plastic handle

Model 61344 stainless steel handle



Specifications

Dimensions: DN25 to DN76 (1" to 3")

Ambient temperature: +90°C max.

Material: Plastic / Stainless steel



Béné Inox – 11 chemin de la Pierre Blanche – 69800 SAINT-PRIEST – S.A.S with 240 000 € share capital – SIREN N° 311 810 287 Tel. N°: +33 (0)4 78 90 48 22 – Fax N°: +33 (0)4 78 90 69 59 – www.bene-inox.com – bene@bene-inox.com

Technical information, illustrations and photographs are provided for information only, they are not contractual. Some may vary according to the tolerances accepted in the profession and the applicable standards. All instructions for use, disassembly and maintenance are recommendations only. These could also vary depending on product usage conditions, its installation environment and purchaser requirements – of which the purchaser alone is responsible for their definition.

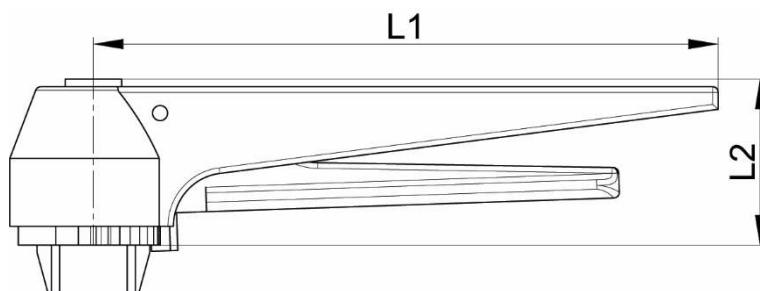

Valve DN (mm)	Valve NB (inches)	L1 (mm)	L2 (mm)	Valve shaft (mm)	Weight (kg)	Part number
25 to 76	1" to 3"	168	50	8 (f lat side)	0.19	961343-2576
25 to 76	1" to 3"	168	50	8 (f lat side)	0.35	261344-2576

13-position handle (within 180°).

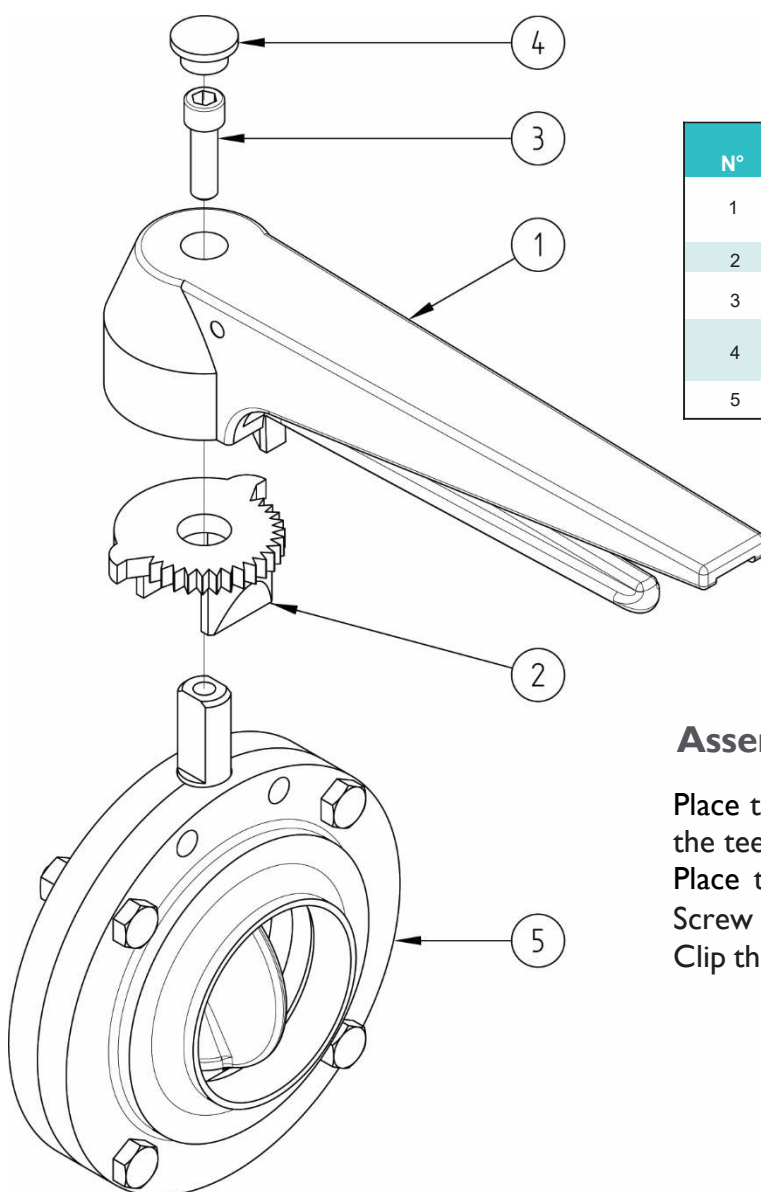

N°	Part Name	Material	Quantity
1	HANDLE	PLASTIC / STAINLESS STEEL	1
2	POSITIONER	STAINLESS STEEL	1
3	SCREW	A2	1
4	PLUG (ONLY WITH THE PLASTIC HANDLE)	PLASTIC	1
5	BUTTERFLY VALVE	STAINLESS STEEL	1

Assembly

Place the positioner **2** on the butterfly valve's shaft (put the teeth on the side where the handle will be).

Place the handle **1** onto the butterfly valve's shaft **5**.

Screw the screw **3** into the butterfly valve's shaft **5**.

Clip the plug **4** on top of the screw in the handle **1**.