

Ball valves

Model 50285 Wafer ball valve with ISO mounting plate (58249) and ATEX electric actuator IP68 (50848)



Specifications

⇒ Valve

Dimensions: DN25 to DN150 (1" to 6")

Connection: flanges in accordance with EN 1092-1

Pressure: PN depending on flange dimensions

Operating Temperature: -29°C to +175°C

Material: 316 or CF8M stainless steel

(for the stainless steel parts that can come into contact with the transported fluid)

⇒ Electric actuator

Operating temperature: -20°C to +70°C

Aluminium housing and cap IP68

Visual position indicator

Anti-condensation heater

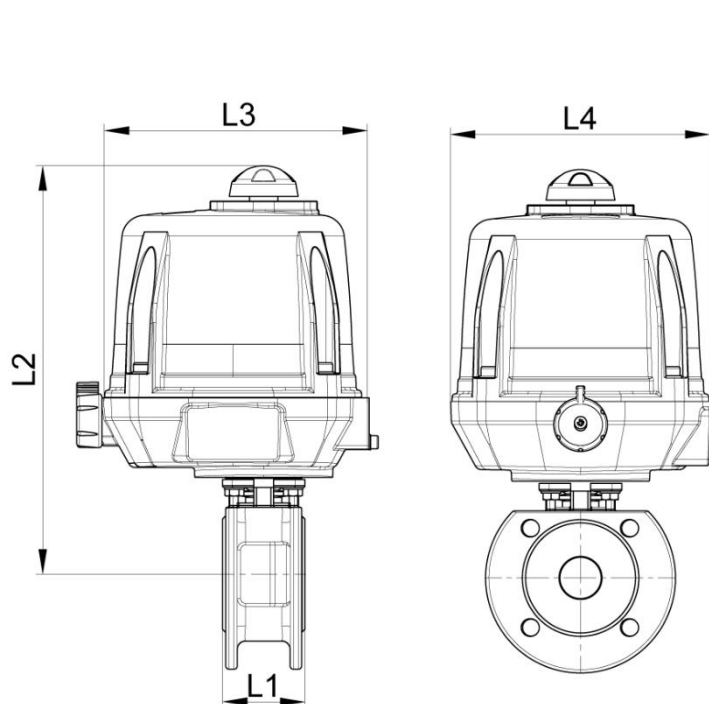

DN25 to DN50

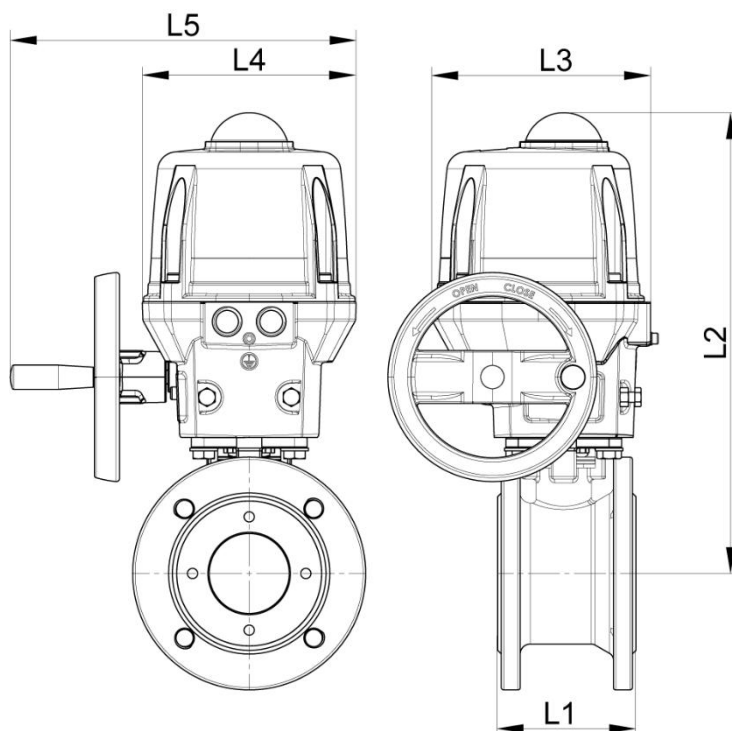

DN65 to DN100

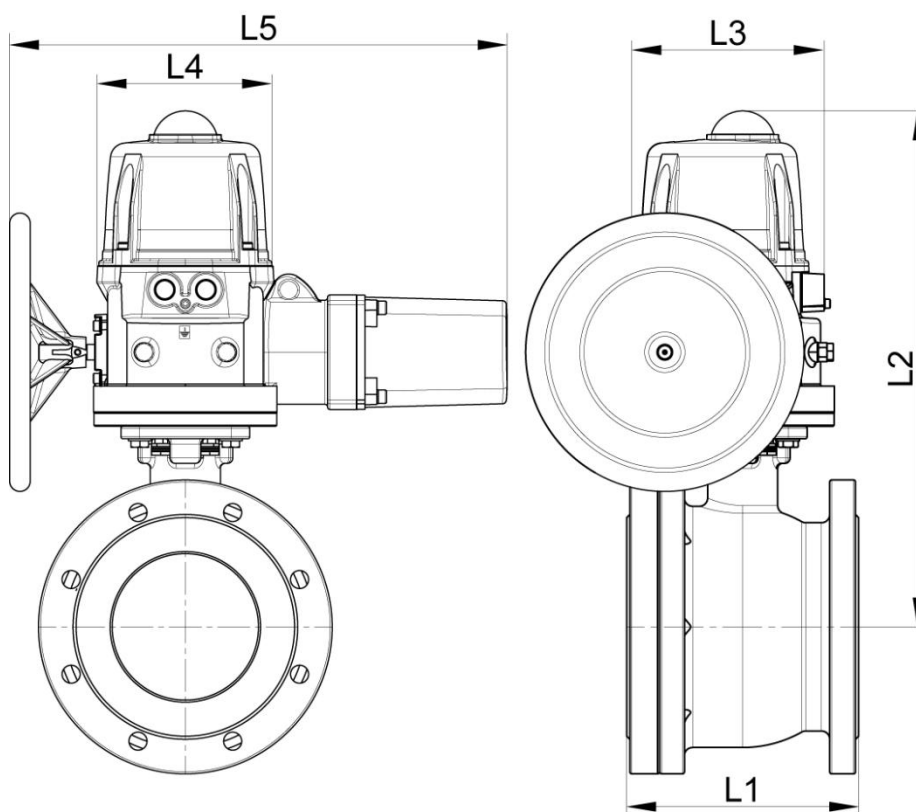

DN125 to DN150

Béné Inox – 11 chemin de la Pierre Blanche – 69800 SAINT-PRIEST – S.A.S with 240 000 € share capital – SIREN N° 311 810 287
Tel. N°: +33 (0)4 78 90 48 22 – Fax N°: +33 (0)4 78 90 69 59 – www.bene-inox.com – bene@bene-inox.com

Technical information, illustrations and photographs are provided for information only, they are not contractual. Some may vary according to the tolerances accepted in the profession and the applicable standards. All instructions for use, disassembly and maintenance are recommendations only. These could also vary depending on product usage conditions, its installation environment and purchaser requirements – of which the purchaser alone is responsible for their definition.

| DN (mm) | NB (inches) | L1 (mm) | L2 (mm) | L3 (mm) | L4 (mm) | L5 (mm) | Opening/ closing time (90°) (s) | Weight (kg) | Part No. 100-230V AC and 100-350V DC |
|------------|----------------|------------|------------|------------|------------|------------|--|----------------|---|
| 25 | 1" | 50 | 260 | 192 | 170 | x | 7 | 6.80 | 450285-25A |
| 32 | 1"1/4 | 60 | 264 | 192 | 170 | x | 7 | 7.70 | 450285-32A |
| 40 | 1"1/2 | 65 | 273 | 192 | 170 | x | 15 | 9.00 | 450285-40A |
| 50 | 2" | 78 | 279 | 192 | 170 | x | 20 | 10.90 | 450285-50A |
| 65 | 2"1/2 | 110 | 358 | 209 | 170 | 275 | 15 | 16.30 | 450285-65A |
| 80 | 3" | 120 | 367 | 209 | 170 | 275 | 30 | 21.00 | 450285-80A |
| 100 | 4" | 150 | 398 | 209 | 170 | 275 | 60 | 28.70 | 450285-100A |
| 125 | 5" | 180 | 482 | 299 | 170 | 483 | 38 | 57.50 | 450285-125A |
| 150 | 6" | 225 | 498 | 299 | 170 | 483 | 38 | 75.00 | 450285-150A |

| DN (mm) | NB (inches) | Opening/ closing time (90°) (s) | Part No. 15-30V AC and 12-48V DC | Opening/ closing time (90°) (s) | Part No. 400V TRI 50/60 Hz |
|------------|----------------|--|---|--|----------------------------------|
| 25 | 1" | 7 | 450285-25B | 10 | 450285-25C |
| 32 | 1"1/4 | 7 | 450285-32B | 10 | 450285-32C |
| 40 | 1"1/2 | 15 | 450285-40B | 10 | 450285-40C |
| 50 | 2" | 20 | 450285-50B | 15 | 450285-50C |
| 65 | 2"1/2 | 15 | 450285-65B | 10 | 450285-65C |
| 80 | 3" | 30 | 450285-80B | 20 | 450285-80C |
| 100 | 4" | 60 | 450285-100B | 35 | 450285-100C |
| 125 | 5" | - | - | 38 | 450285-125C |
| 150 | 6" | - | - | 38 | 450285-150C |

ATEX 1/4 turn (90°) electric actuator with aluminium housing and cap IP68.
 Visual position indicator. Manual override control with safe clutch disengagement.
 Configurable limit switches. Torque limiting device. Anti-condensation heater.
 Actuator operating temperature: -20°C to +70°C.
 Duty cycle: 50%. Number of starts per hour: 150.
 Actuator sized for a valve $\Delta P = \max. 16 \text{ bar}$. For $\Delta P > 16 \text{ bar}$, please contact us.
 Standard operation: Opening/closing at 0/90°.

You must order earthing braids separately.
 Cable glands are not supplied.

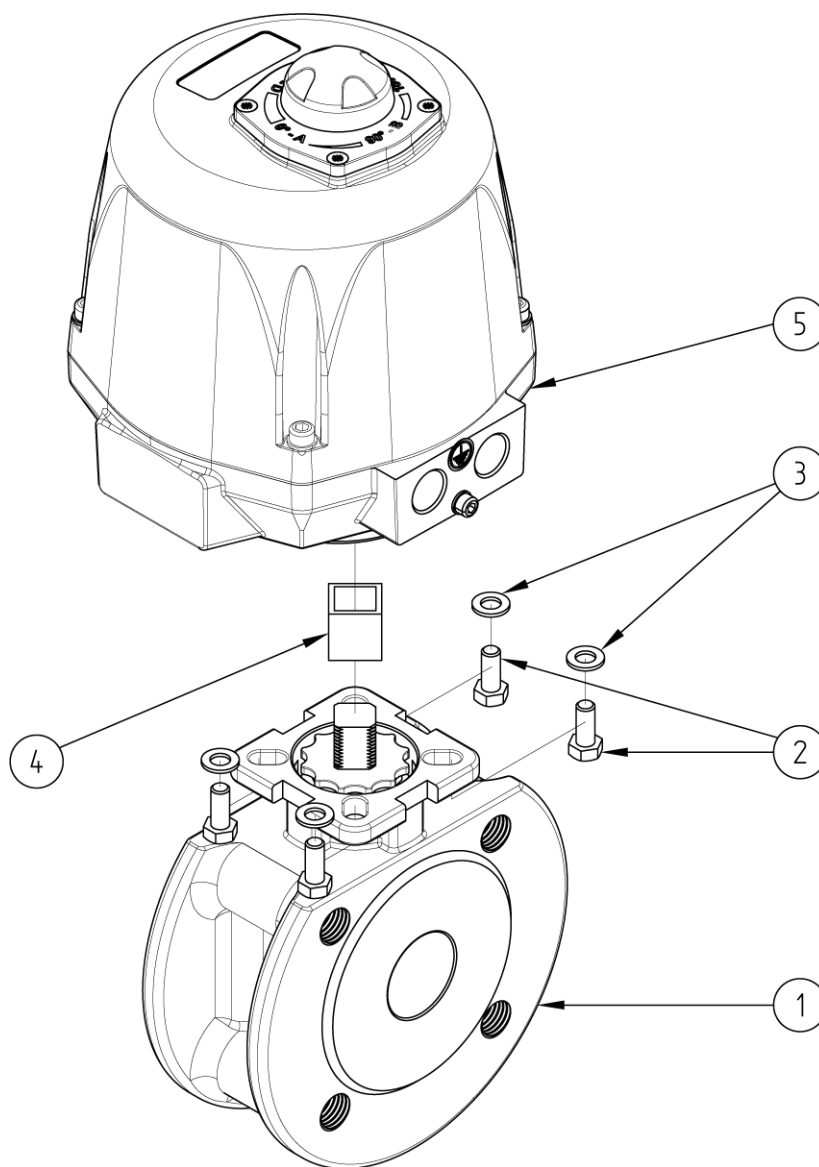

| N° | Part Name | Material | Quantity |
|----|---------------------------|-----------------|----------|
| 1 | WAFFER VALVE (58249) | CF8M | 1 |
| 2 | FIXING BOLT | STAINLESS STEEL | 4 |
| 3 | WASHER | STAINLESS STEEL | 4 |
| 4 | COUPLING | STAINLESS STEEL | 0 or 1 |
| 5 | ELECTRIC ACTUATOR (50848) | ALUMINIUM | 1 |

You can refer to the following product data sheets for more technical information:

- **58249** : Wafer valve
- **50848** : ATEX 1/4 turn (90°) electric actuator - IP68