

# Ball valves

## Model 50282 Wafer ball valve with ISO mounting plate (58249) and fail-safe electric actuator IP68 (50845)



### Specifications

#### ⇒ Valve

**Dimensions:** DN25 to DN150 (1" to 6")

**Connection:** flanges in accordance with EN 1092-1

**Pressure:** PN depending on flange dimensions

**Operating Temperature:** -29°C to +175°C

**Material:** 316 or CF8M stainless steel  
(for the stainless steel parts that can come into contact with the transported fluid)

#### ⇒ Electric actuator

**Operating temperature:** -10°C to +40°C

Aluminium housing and plastic cap IP68

Visual position indicator

Self-regulating anti-condensation heater

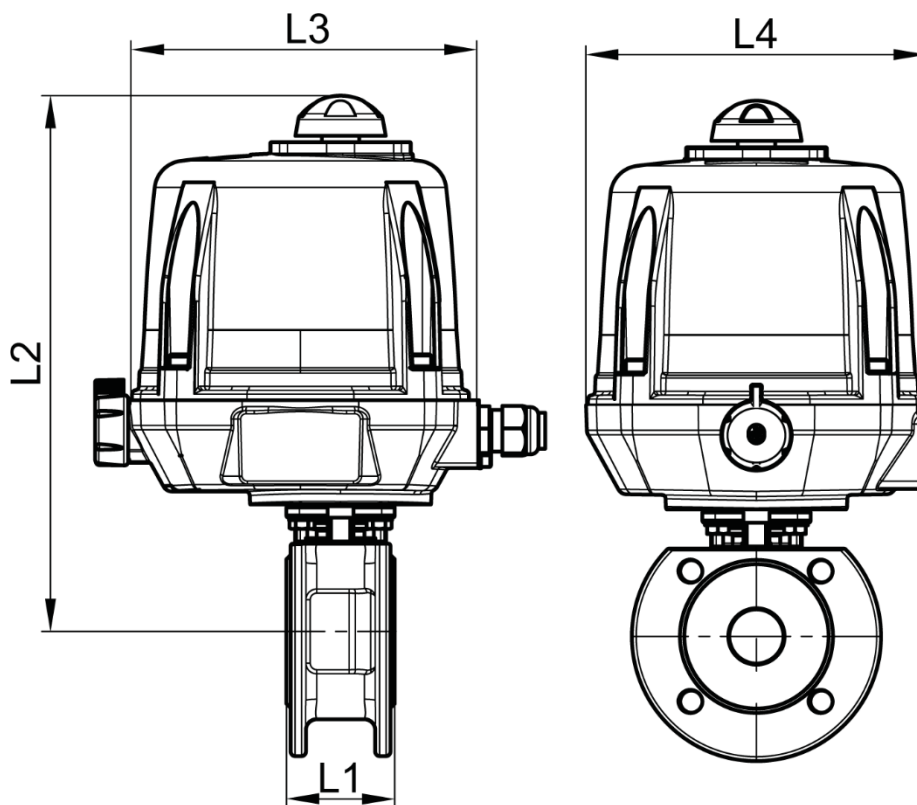

**DN20 to DN50**

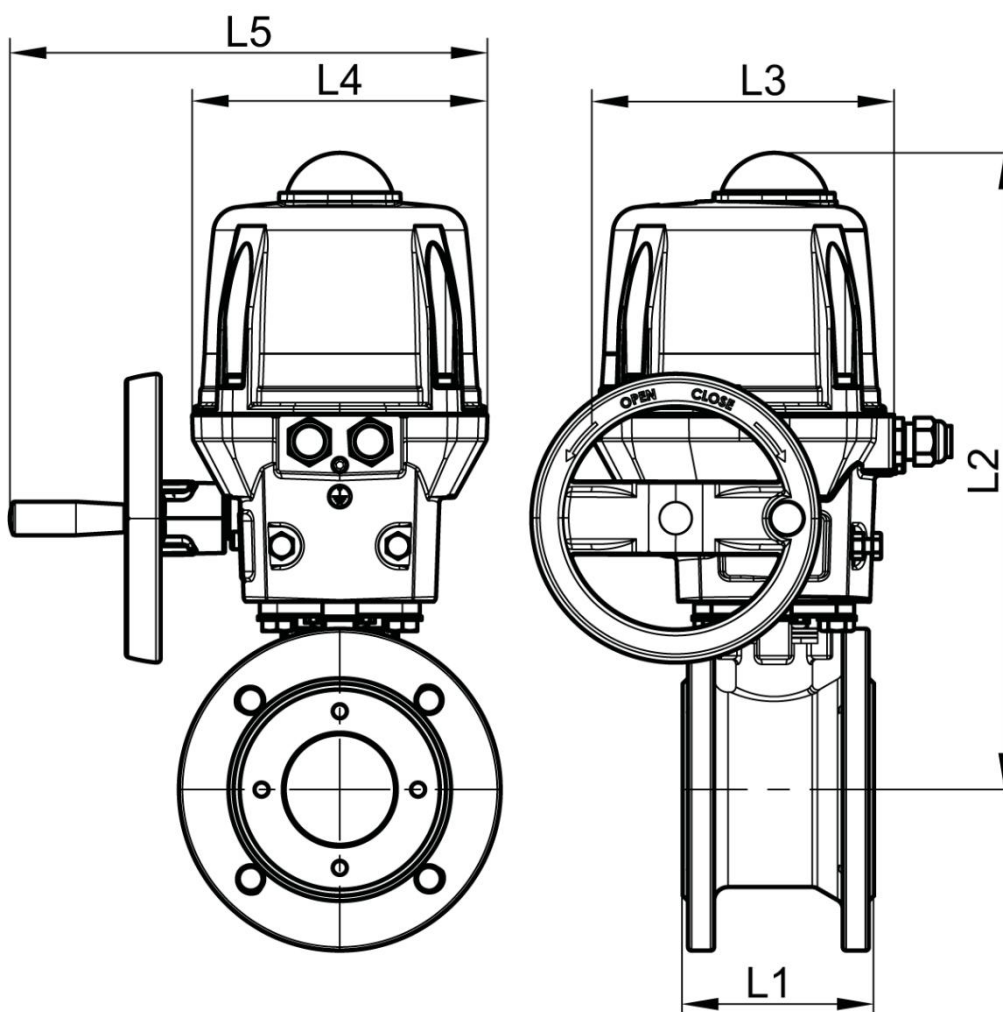

**DN65 to DN100**

**Béné Inox** – 11 chemin de la Pierre Blanche – 69800 SAINT-PRIEST – S.A.S with 240 000 € share capital – SIREN N° 311 810 287  
Tel. N°: +33 (0)4 78 90 48 22 – Fax N°: +33 (0)4 78 90 69 59 – [www.bene-inox.com](http://www.bene-inox.com) – [bene@bene-inox.com](mailto:bene@bene-inox.com)

Technical information, illustrations and photographs are provided for information only, they are not contractual. Some may vary according to the tolerances accepted in the profession and the applicable standards. All instructions for use, disassembly and maintenance are recommendations only. These could also vary depending on product usage conditions, its installation environment and purchaser requirements – of which the purchaser alone is responsible for their definition.

DN (mm)	NB (inches)	L1 (mm)	L2 (mm)	L3 (mm)	L4 (mm)	L5 (mm)	Opening/ closing time (90°) (s)	Weight (kg)	Part No. 100-230V AC and 100-350V DC	Part No. 15-30V AC and 12-48V DC
25	1"	50	260	192	170	x	7	6.10	450282-25A	450282-25B
32	1"1/4	60	264	192	170	x	7	7.00	450282-32A	450282-32B
40	1"1/2	65	273	192	170	x	15	8.30	450282-40A	450282-40B
50	2"	78	279	192	170	x	20	10.20	450282-50A	450282-50B
65	2"1/2	110	358	209	170	275	15	15.60	450282-65A	450282-65B
80	3"	120	367	209	170	275	30	20.30	450282-80A	450282-80B
100	4"	150	398	209	170	275	60	28.00	450282-100A	450282-100B

Electric actuator with aluminium housing and plastic cap with IP68 protection rating.

Visual position indicator. Manual override control with safe clutch disengagement.

Configurable limit switches. Torque limiting device. Anti-condensation heater.

Actuator operating temperature: -10°C to +40°C.

Duty cycle: 50%. Number of starts per hour: 150.

Actuator sized for a valve  $\Delta P = \max$ . 16 bar. For  $\Delta P > 16$  bar, please contact us.

Fail-safe version: The internal fail-safe backup unit (circuit board + battery) makes sure that the valve returns to the closed position if there is a power cut.

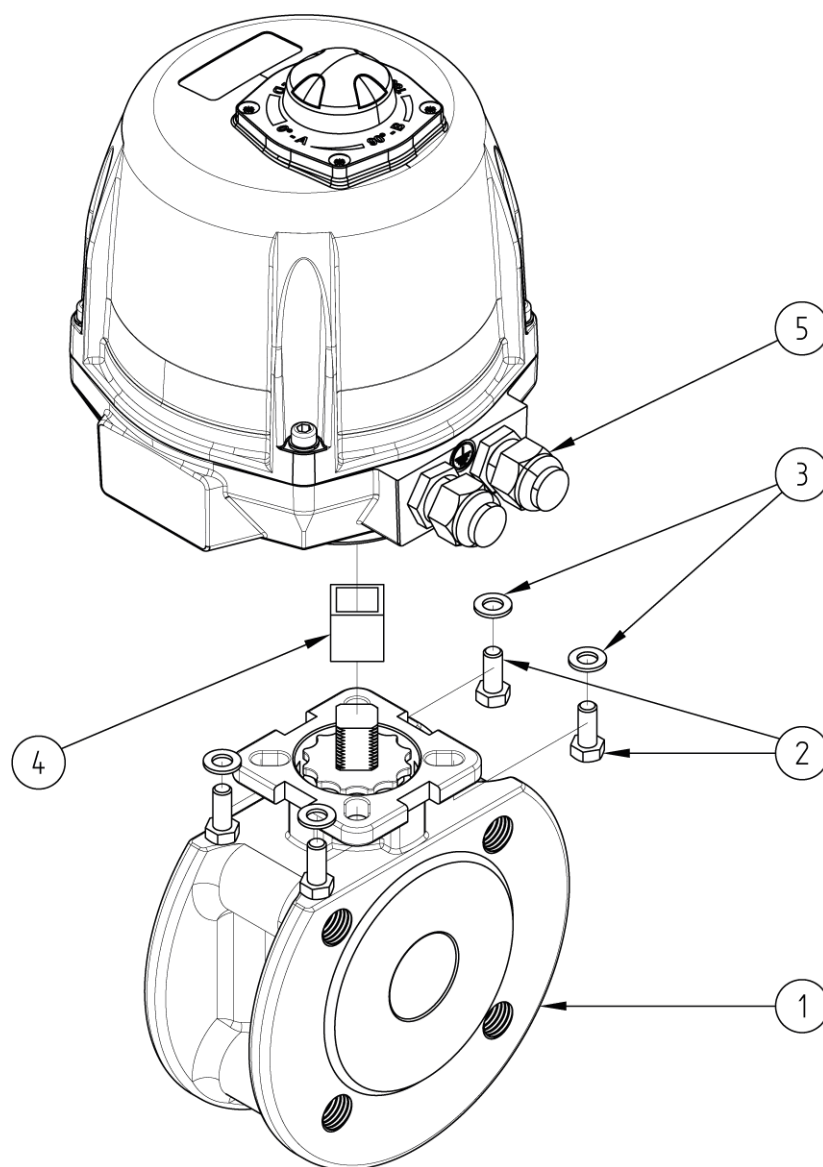

N°	Part Name	Material	Quantity
1	WAFER VALVE (58249)	CF8M	1
2	FIXING BOLT	STAINLESS STEEL	4
3	WASHER	STAINLESS STEEL	4
4	COUPLING	STAINLESS STEEL	0 or 1
5	ELECTRIC ACTUATOR (50845)	ALUMINIUM/PLASTIC	1

You can refer to the following product data sheets for more technical information:

- **58249-LMOD1** : Wafer valve
- **50845-LMOD1** : Fail-safe ¼ turn (90°) electric actuator - IP68