

# Ball valves

## Model 50281 Wafer ball valve with ISO mounting plate (58249) and electric actuator IP68 (50844)



### Specifications

#### ⇒ Valve

**Dimensions:** DN25 to DN150 (1" to 6")

**Connection:** flanges in accordance with EN 1092-1

**Pressure:** PN depending on flange dimensions

**Operating Temperature:** -29°C to +175°C

**Material:** 316 or CF8M stainless steel  
(for the stainless steel parts that can come into contact with the transported fluid)

#### ⇒ Electric actuator

**Operating temperature:** -20°C to +70°C

Aluminium housing and plastic cap IP68

Visual position indicator

Self-regulating anti-condensation heater

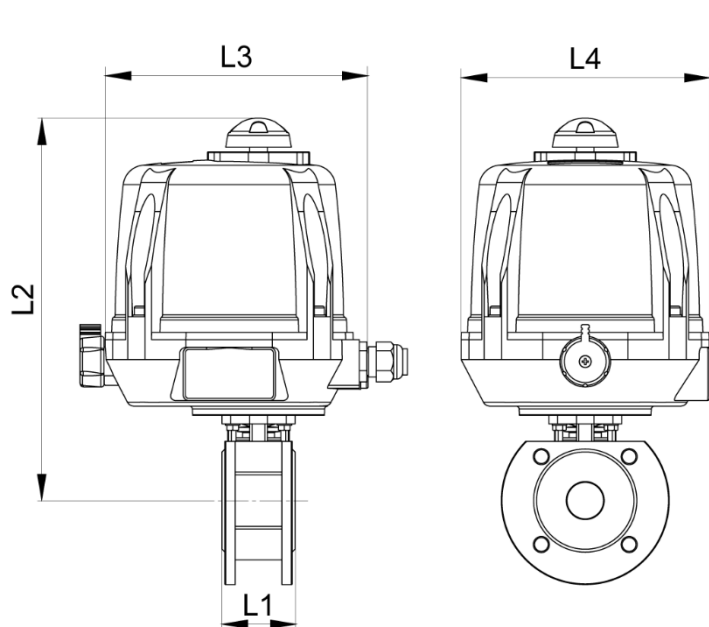

**DN25 to DN50**

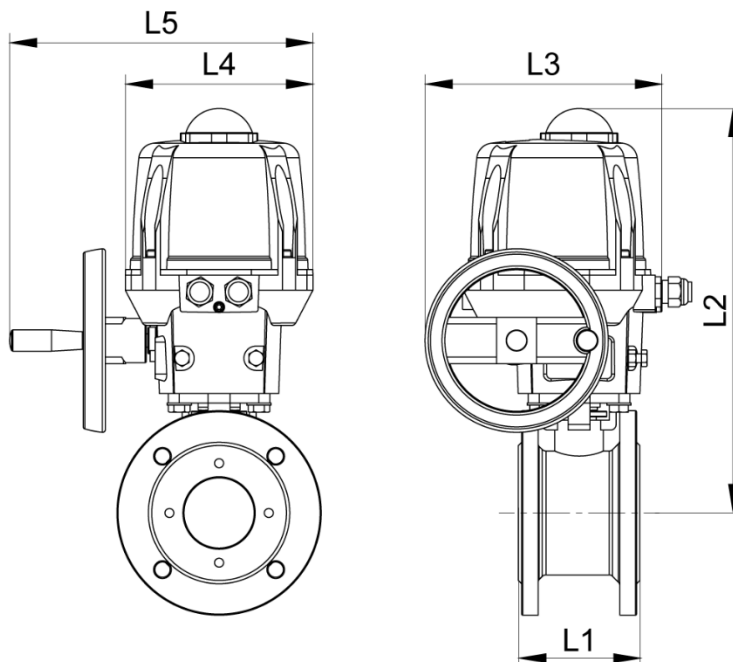

**DN65 to DN100**

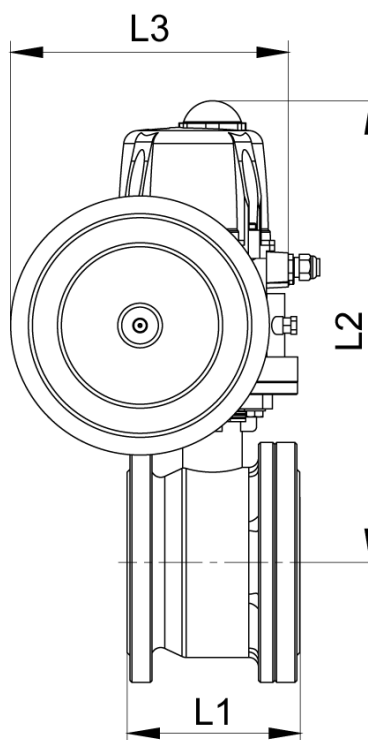
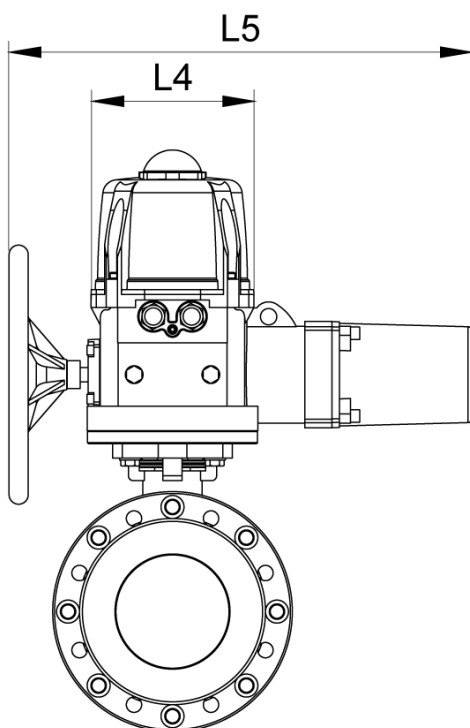

**DN125 to DN150**

**Béné Inox** – 11 chemin de la Pierre Blanche – 69800 SAINT-PRIEST – S.A.S with 240 000 € share capital – SIREN N° 311 810 287  
Tel. N°: +33 (0)4 78 90 48 22 – Fax N°: +33 (0)4 78 90 69 59 – [www.bene-inox.com](http://www.bene-inox.com) – [bene@bene-inox.com](mailto:bene@bene-inox.com)

Technical information, illustrations and photographs are provided for information only, they are not contractual. Some may vary according to the tolerances accepted in the profession and the applicable standards. All instructions for use, disassembly and maintenance are recommendations only. These could also vary depending on product usage conditions, its installation environment and purchaser requirements – of which the purchaser alone is responsible for their definition.

DN (mm)	NB (inches)	L1 (mm)	L2 (mm)	L3 (mm)	L4 (mm)	L5 (mm)	Opening/ closing time (90°) (s)	Weight (kg)	Part No. 100-230V AC and 100-350V DC
25	1"	50	260	192	170	x	7	5.90	450281-25A
32	1"1/4	60	264	192	170	x	7	6.80	450281-32A
40	1"1/2	65	273	192	170	x	15	8.10	450281-40A
50	2"	78	279	192	170	x	20	10.00	450281-50A
65	2"1/2	110	358	209	170	275	15	15.40	450281-65A
80	3"	120	367	209	170	275	30	20.10	450281-80A
100	4"	150	398	209	170	275	60	27.80	450281-100A
125	5"	180	482	299	170	483	38	56.50	450281-125A
150	6"	225	498	299	170	483	38	74.00	450281-150A

DN (mm)	NB (inches)	Opening/ closing time (90°) (s)	Part No. 15-30V AC and 12-48V DC	Opening/ closing time (90°) (s)	Part No. 400V TRI 50/60 Hz
25	1"	7	450281-25B	10	450281-25C
32	1"1/4	7	450281-32B	10	450281-32C
40	1"1/2	15	450281-40B	10	450281-40C
50	2"	20	450281-50B	15	450281-50C
65	2"1/2	15	450281-65B	10	450281-65C
80	3"	30	450281-80B	20	450281-80C
100	4"	60	450281-100B	35	450281-100C
125	5"	-	-	38	450281-125C
150	6"	-	-	38	450281-150C

Electric actuator with aluminium housing and plastic cap with IP68 protection rating.

Visual position indicator. Manual override control with safe clutch disengagement.

Configurable limit switches. Torque limiting device. Anti-condensation heater.

Actuator operating temperature: -20°C to +70°C.

Duty cycle: 50%. Number of starts per hour: 150.

Actuator sized for a valve  $\Delta P = \max$ . 16 bar. For  $\Delta P > 16$  bar, please contact us.

Standard operation: Opening/closing at 0/90°.

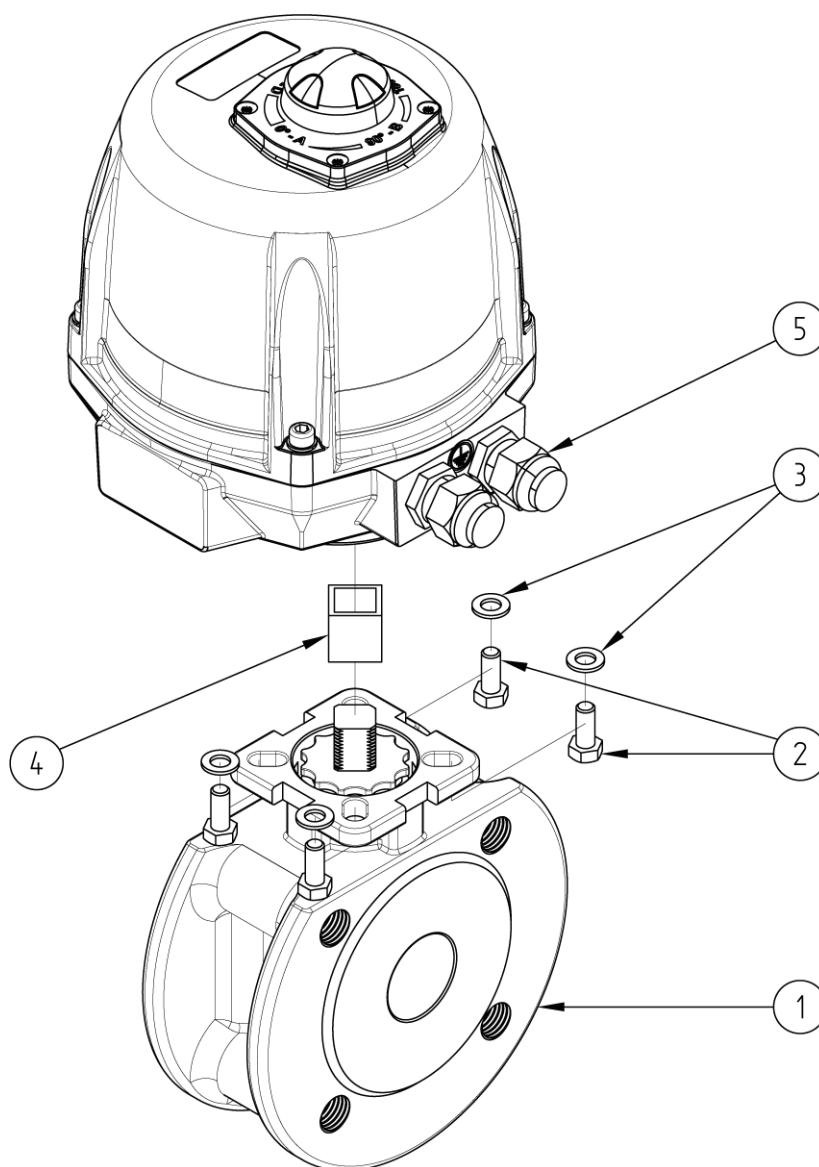

N°	Part Name	Material	Quantity
1	WAFFER VALVE (58249)	CF8M	1
2	FIXING BOLT	STAINLESS STEEL	4
3	WASHER	STAINLESS STEEL	4
4	COUPLING	STAINLESS STEEL	0 or 1
5	ELECTRIC ACTUATOR (50844)	ALUMINIUM/PLASTIC	1

You can refer to the following product data sheets for more technical information:

- **58249** : Wafer valve
- **50844** : 1/4 turn (90°) electric actuator - IP68