

Ball valves

Model 50273 Wafer ball valve with ISO mounting plate (58249) and electric actuator IP65 (50835)



Specifications

⇒ Valve

Dimensions: DN15 to DN80 (1/2" to 3")

Connection: flanges in accordance with EN 1092-1

Pressure: PN depending on flange dimensions

Operating Temperature: -29°C to +175°C

Material: 316 or 1.4408 stainless steel

(for the stainless steel parts that can come into contact with the transported fluid)

⇒ Electric actuator

Operating temperature: -10°C to +50°C

Material: Plastic

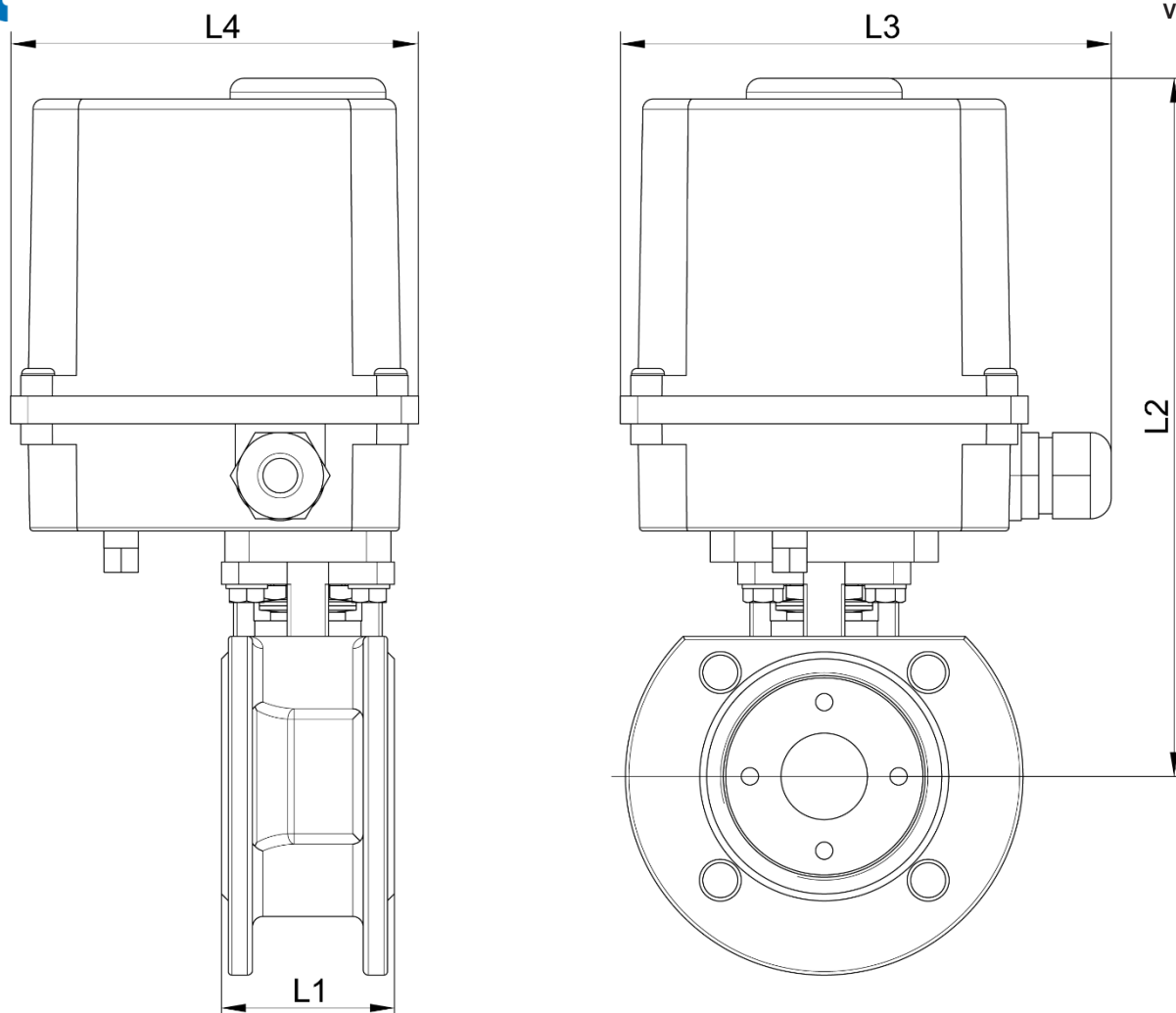

DN (mm)	NB (inches)	L1 (mm)	L2 (mm)	L3 (mm)	L4 (mm)	Opening/ closing time (s)	Weight (kg)	Part No. 230V 50Hz
15	1/2"	42	185	143	118	10	3.00	450273-15A
20	3/4"	43	192	143	118	10	3.20	450273-20A
25	1"	50	202	143	118	10	4.20	450273-25A
32	1"1/4	60	206	143	118	10	5.10	450273-32A
40	1"1/2	65	215	143	118	10	6.40	450273-40A
50	2"	78	245	204	165	8	10.90	450273-50A
65	2"1/2	110	267	204	165	8	14.30	450273-65A
80	3"	120	276	204	165	8	19.00	450273-80A

DN (mm)	NB (inches)	Opening/ closing time (s)	Part No. 24V 50Hz	Opening/ closing time (s)	Part No. 24V DC
15	1/2"	15	450273-15B	16	450273-15C
20	3/4"	15	450273-20B	16	450273-20C
25	1"	15	450273-25B	16	450273-25C
32	1"1/4	15	450273-32B	16	450273-32C
40	1"1/2	15	450273-40B	16	450273-40C

Béné Inox – 11 chemin de la Pierre Blanche – 69800 SAINT-PRIEST – S.A.S with 240 000 € share capital – SIREN N° 311 810 287
Tel. N°: +33 (0)4 78 90 48 22 – Fax N°: +33 (0)4 78 90 69 59 – www.bene-inox.com – bene@bene-inox.com

Technical information, illustrations and photographs are provided for information only, they are not contractual. Some may vary according to the tolerances accepted in the profession and the applicable standards. All instructions for use, disassembly and maintenance are recommendations only. These could also vary depending on product usage conditions, its installation environment and purchaser requirements – of which the purchaser alone is responsible for their definition.

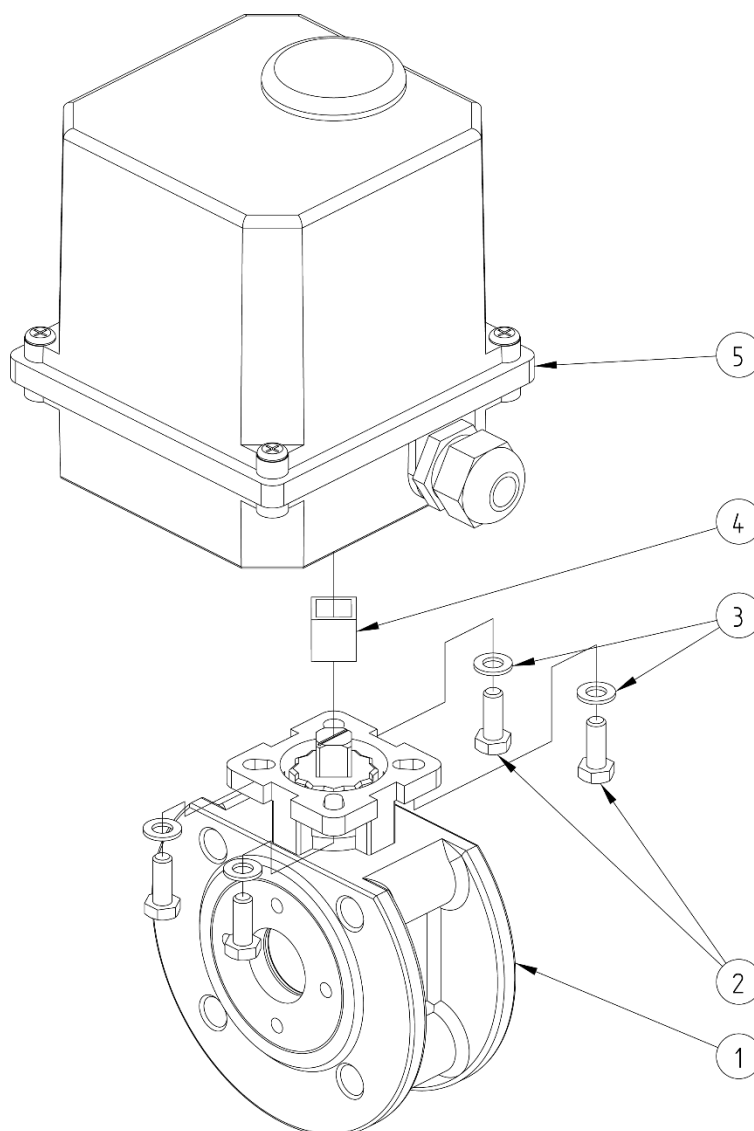

N°	Part Name	Material	Quantity
1	WAFER VALVE (58249)	1.4408	1
2	FIXING BOLT	STAINLESS STEEL	4
3	WASHER	STAINLESS STEEL	4
4	COUPLING	STAINLESS STEEL	0 or 1
5	ELECTRIC ACTUATOR (50835)	PLASTIC	1

You can refer to the following product data sheets for more technical information:

- **58249** : Wafer valve
- **50835** : Electric actuator