

Ball valves

Model 50269 3-way ball valve with flanges and T-shaped bore (58227) and fail-safe ATEX electric actuator IP68 (50849)



Specifications

⇒ Valve

Dimensions: DN20 to DN100 (3/4" to 4")

Connection: with flanges

Pressure: PN depending on flange dimensions

Operating Temperature: -29°C to +175°C

Material: 316 or CF8M stainless steel

(for the stainless steel parts that can come into contact with the transported fluid)

⇒ Electric actuator

Operating temperature: -10°C to +40°C

Aluminium housing and cap IP68

Visual position indicator

Anti-condensation heater

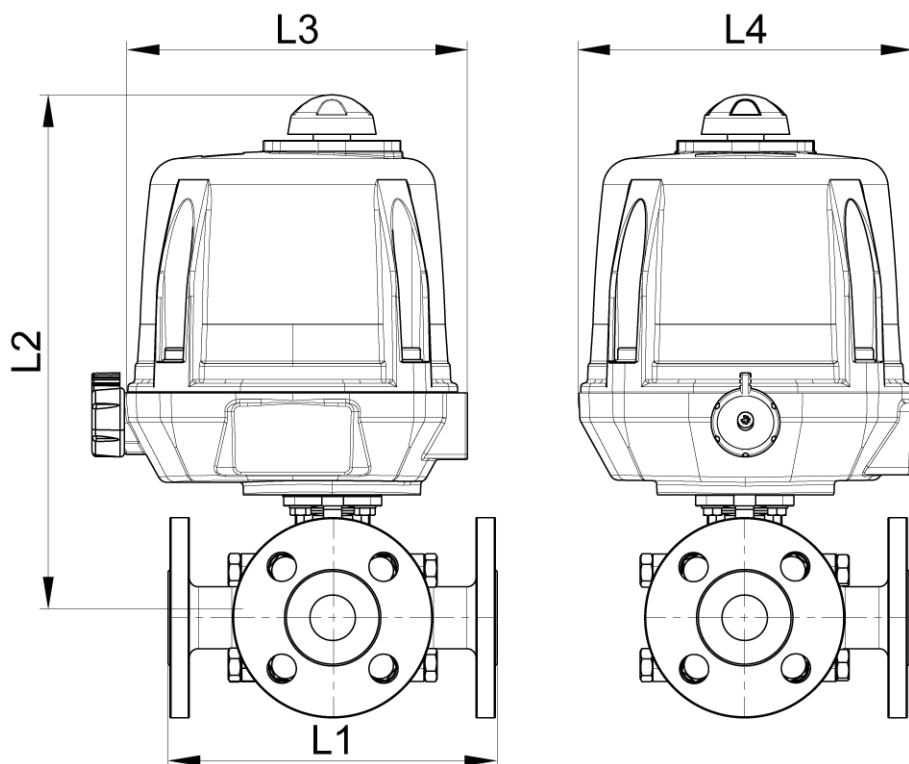

DN20 to DN50

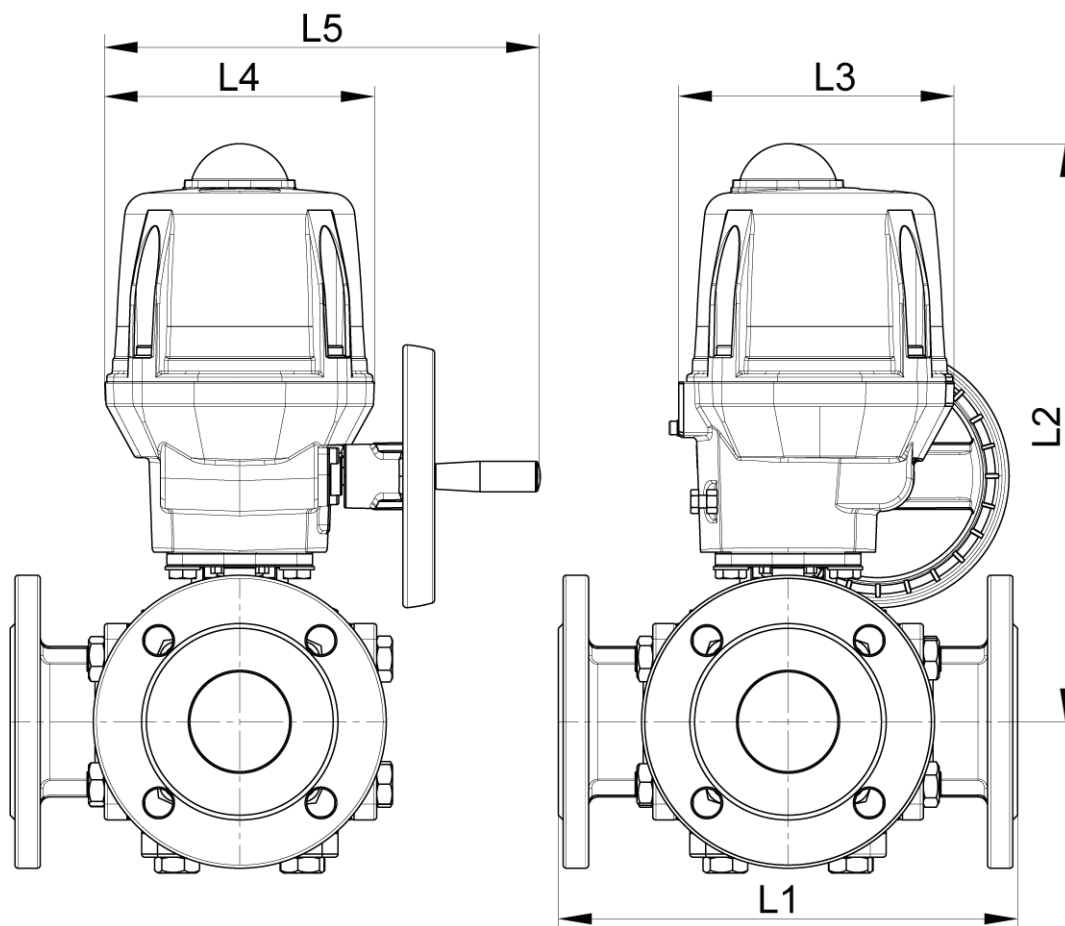

DN65 to DN100

Béné Inox – 11 chemin de la Pierre Blanche – 69800 SAINT-PRIEST – S.A.S with 240 000 € share capital – SIREN N° 311 810 287
Tel. N°: +33 (0)4 78 90 48 22 – Fax N°: +33 (0)4 78 90 69 59 – www.bene-inox.com – bene@bene-inox.com

Technical information, illustrations and photographs are provided for information only, they are not contractual. Some may vary according to the tolerances accepted in the profession and the applicable standards. All instructions for use, disassembly and maintenance are recommendations only. These could also vary depending on product usage conditions, its installation environment and purchaser requirements – of which the purchaser alone is responsible for their definition.

DN (mm)	NB (inches)	L1 (mm)	L2 (mm)	L3 (mm)	L4 (mm)	L5 (mm)	Opening/ closing time (90°) (s)	Weight (kg)	Part No. 100-230V AC and 100-350V DC	Part No. 15-30V AC and 12-48V DC
20	3/4"	165	258	192	170	x	7	11.70	450269-20A	450269-20B
25	1"	181	269	192	170	x	7	13.20	450269-25A	450269-25B
32	1"1/4	190	273	192	170	x	15	15.20	450269-32A	450269-32B
40	1"1/2	212	286	192	170	x	20	17.60	450269-40A	450269-40B
50	2"	230	293	192	170	x	20	26.60	450269-50A	450269-50B
65	2"1/2	290	365	209	170	275	15	37.90	450269-65A	450269-65B
80	3"	310	377	209	170	275	30	52.90	450269-80A	450269-80B
100	4"	352	408	209	170	275	60	78.90	450269-100A	450269-100B

ATEX 1/4 turn (90°) electric actuator with aluminium housing and cap IP68.

Visual position indicator. Manual override control with safe clutch disengagement.

Configurable limit switches. Torque limiting device. Anti-condensation heater.

Actuator operating temperature: -10°C to +40°C.

Duty cycle: 50%. Number of starts per hour: 150.

Actuator sized for a valve $\Delta P = \max$. 16 bar. For $\Delta P > 16$ bar, please contact us.

Fail-safe version: The internal fail-safe backup unit (circuit board + battery) makes sure that the valve returns to the closed position if there is a power cut.

You must order earthing braids separately.

Cable glands are not supplied.

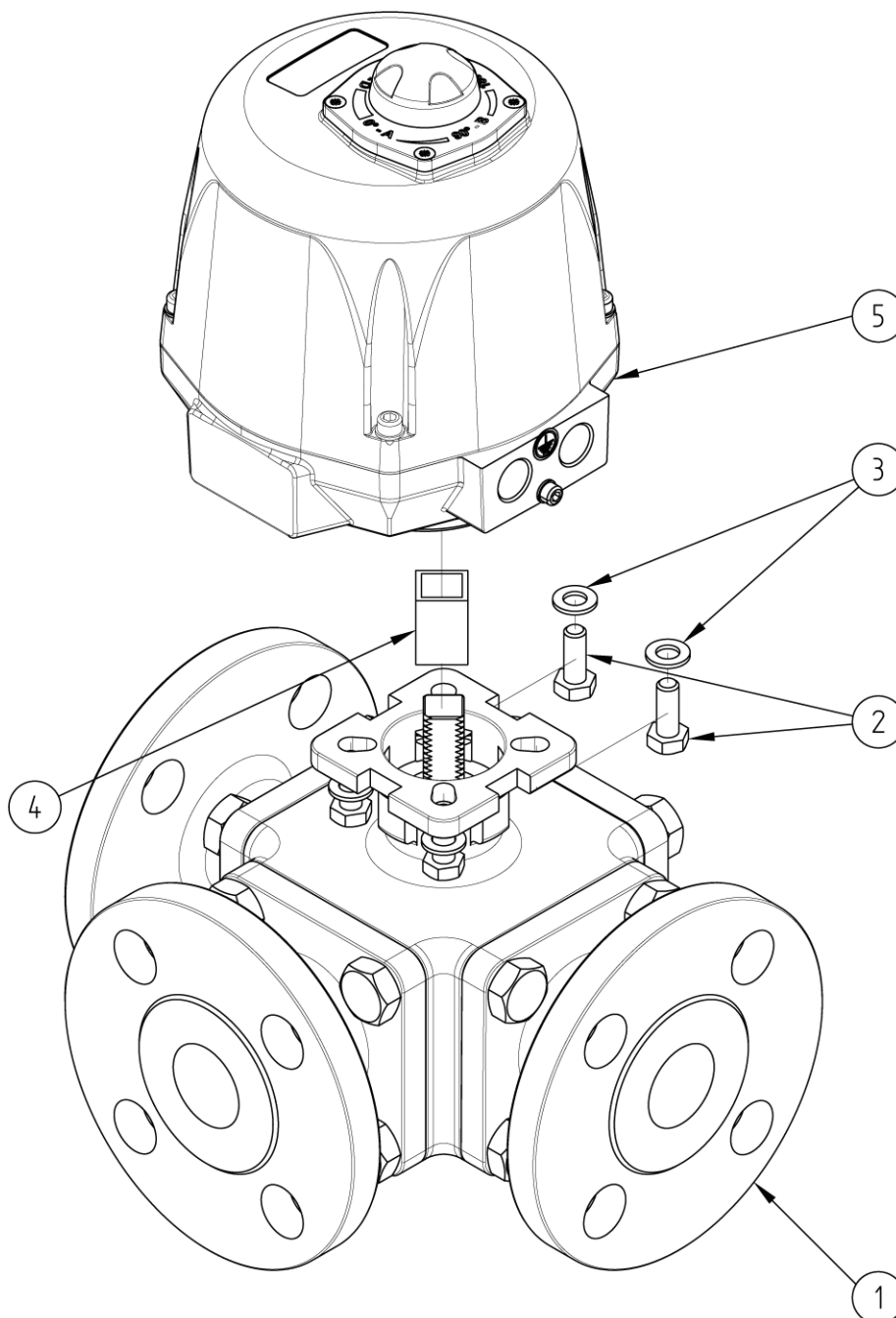

N°	Part Name	Material	Quantity
1	3-WAY VALVE WITH FLANGES (58227)	CF8M	1
2	FIXING BOLT	STAINLESS STEEL	4
3	WASHER	STAINLESS STEEL	4
4	COUPLING	STAINLESS STEEL	0 or 1
5	ELECTRIC ACTUATOR (50849)	ALUMINIUM	1

You can refer to the following product data sheets for more technical information:

- **58227** : 3-way valve with flanges - T-shaped bore
- **50849** : Fail-safe ATEX ¼ turn (90°) electric actuator - IP68

Béné Inox – 11 chemin de la Pierre Blanche – 69800 SAINT-PRIEST – S.A.S with 240 000 € share capital – SIREN N° 311 810 287
Tel. N°: +33 (0)4 78 90 48 22 – Fax N°: +33 (0)4 78 90 69 59 – www.bene-inox.com – bene@bene-inox.com

Technical information, illustrations and photographs are provided for information only, they are not contractual. Some may vary according to the tolerances accepted in the profession and the applicable standards. All instructions for use, disassembly and maintenance are recommendations only. These could also vary depending on product usage conditions, its installation environment and purchaser requirements – of which the purchaser alone is responsible for their definition.