

# Ball valves

**Model 50253** 3-way ball valve with flanges and T-shaped bore (58227) and electric actuator IP66 (50840)



## Specifications

### ⇒ Valve

**Dimensions:** DN15 to DN80 (1/2" to 3")

**Connection:** with flanges

**Pressure:** PN depending on flange dimensions

**Operating Temperature:** -29°C to +175°C

**Material:** 316 or CF8M stainless steel

(for the stainless steel parts that can come into contact with the transported fluid)

### ⇒ Electric actuator

**Operating temperature:** -10°C to +55°C

Plastic housing IP66

Visual position indicator

Anti-condensation heater

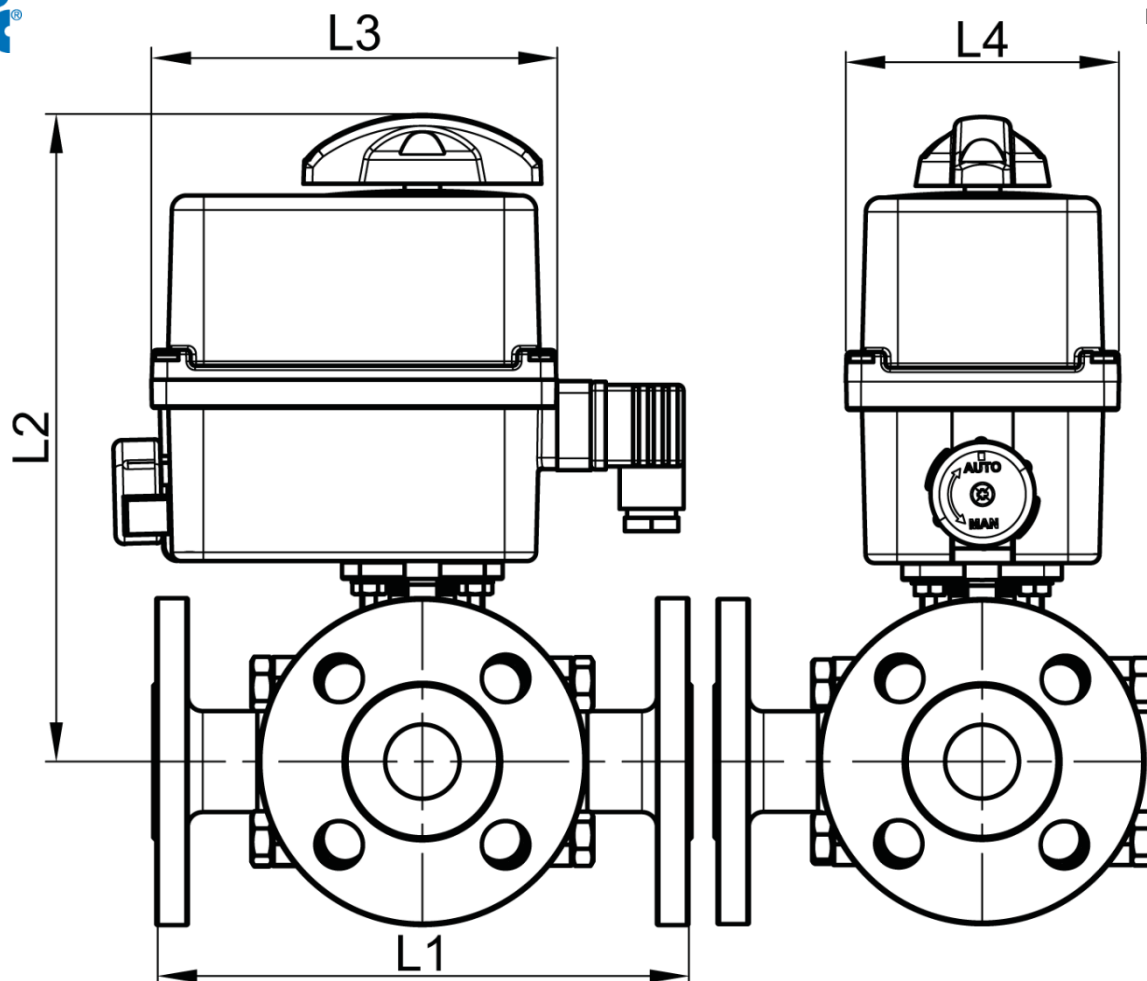

| DN<br>(mm) | NB<br>(inches) | L1<br>(mm) | L2<br>(mm) | L3<br>(mm) | L4<br>(mm) | Opening/<br>closing time<br>(90°)<br>(s) | Weight<br>(kg) | Part No.<br>100-230V AC<br>and<br>100-350V DC | Opening/<br>closing<br>time (90°)<br>(s) | Part No.<br>15-30V AC<br>and<br>12-48V DC |
|------------|----------------|------------|------------|------------|------------|--|----------------|---|--|---|
| 15         | 1/2"           | 150        | 205        | 136        | 92         | 12                                       | 7.30           | 450253-15A                                    | 12                                       | 450253-15B                                |
| 20         | 3/4"           | 165        | 209        | 136        | 92         | 12                                       | 8.30           | 450253-20A                                    | 12                                       | 450253-20B                                |
| 25         | 1"             | 181        | 220        | 136        | 92         | 26                                       | 9.80           | 450253-25A1                                   | 24                                       | 450253-25B1                               |
| 25         | 1"             | 181        | 244        | 151        | 128        | 7  | 10.90          | 450253-25A2                                   | 7  | 450253-25B2                               |
| 32         | 1 1/4"         | 190        | 224        | 136        | 92         | 26                                       | 11.80          | 450253-32A1                                   | 24                                       | 450253-32B1                               |
| 32         | 1 1/4"         | 190        | 248        | 151        | 128        | 7  | 12.90          | 450253-32A2                                   | 7  | 450253-32B2                               |
| 40         | 1 1/2"         | 212        | 261        | 151        | 128        | 12                                       | 15.30          | 450253-40A                                    | 12                                       | 450253-40B                                |
| 50         | 2"             | 230        | 268        | 151        | 128        | 23                                       | 24.30          | 450253-50A                                    | 22                                       | 450253-50B                                |
| 65         | 2 1/2"         | 290        | 283        | 151        | 128        | 23                                       | 33.60          | 450253-65A                                    | 22                                       | 450253-65B                                |
| 80         | 3"             | 310        | 295        | 151        | 128        | 23                                       | 48.60          | 450253-80A                                    | 22                                       | 450253-80B                                |

Electric actuator with plastic housing with IP66 protection rating.  
 Visual position indicator. Manual override control with safe clutch disengagement.  
 Configurable limit switches. Torque limiting device. Anti-condensation heater.  
 Actuator operating temperature: -10°C to +55°C.  
 Duty cycle: 50%. Number of starts per hour: 150.  
 Actuator sized for a valve  $\Delta P = \max$ . 16 bar. For  $\Delta P > 16$  bar, please contact us.  
 Standard operation: Opening/closing at 0/90°.

**Béné Inox** – 11 chemin de la Pierre Blanche – 69800 SAINT-PRIEST – S.A.S with 240 000 € share capital – SIREN N° 311 810 287  
 Tel. N°: +33 (0)4 78 90 48 22 – Fax N°: +33 (0)4 78 90 69 59 – [www.bene-inox.com](http://www.bene-inox.com) – [bene@bene-inox.com](mailto:bene@bene-inox.com)

Technical information, illustrations and photographs are provided for information only, they are not contractual. Some may vary according to the tolerances accepted in the profession and the applicable standards. All instructions for use, disassembly and maintenance are recommendations only. These could also vary depending on product usage conditions, its installation environment and purchaser requirements – of which the purchaser alone is responsible for their definition.

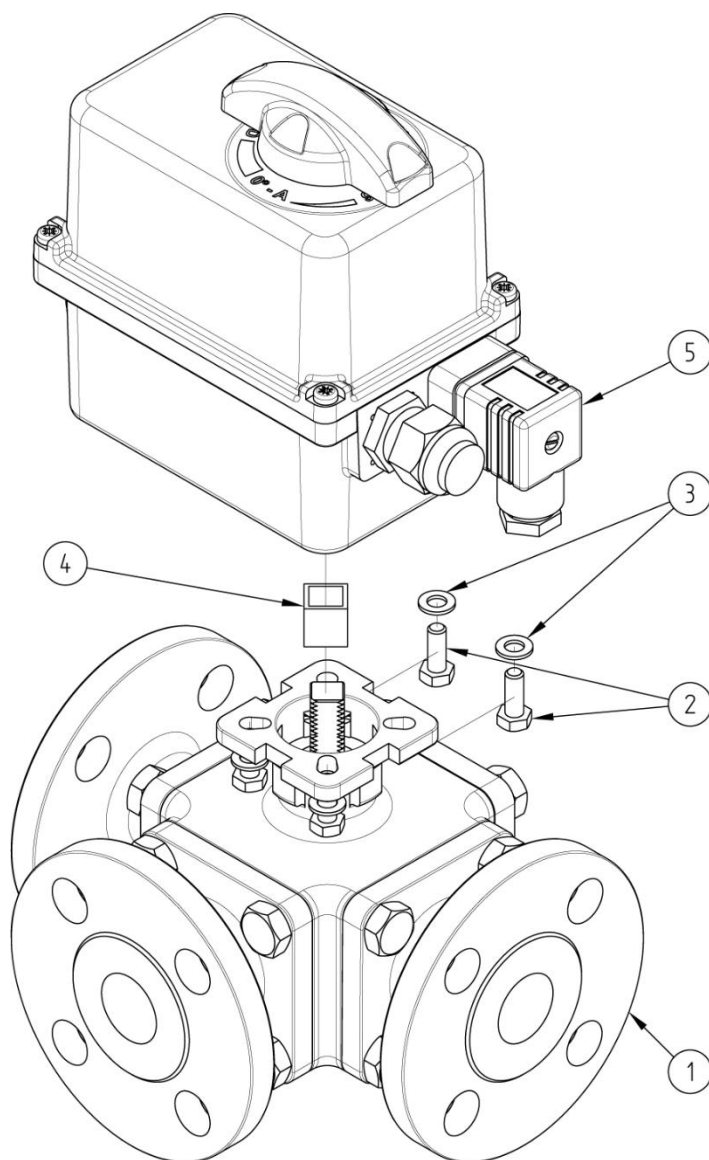

| N° | Part Name                           | Material        | Quantity |
|----|-------------------------------------|-----------------|----------|
| 1  | 3-WAY VALVE WITH FLANGES<br>(58227) | CF8M            | 1        |
| 2  | FIXING BOLT                         | STAINLESS STEEL | 4        |
| 3  | WASHER                              | STAINLESS STEEL | 4        |
| 4  | COUPLING                            | STAINLESS STEEL | 0 or 1   |
| 5  | ELECTRIC ACTUATOR (50840)           | PLASTIC         | 1        |

You can refer to the following product data sheets for more technical information:

- **58227** : 3-way valve with flanges - T-shaped bore
- **50840** : ¼ turn (90°) electric actuator - IP66

**Béné Inox** – 11 chemin de la Pierre Blanche – 69800 SAINT-PRIEST – S.A.S with 240 000 € share capital – SIREN N° 311 810 287  
Tel. N°: +33 (0)4 78 90 48 22 – Fax N°: +33 (0)4 78 90 69 59 – [www.bene-inox.com](http://www.bene-inox.com) – [bene@bene-inox.com](mailto:bene@bene-inox.com)

Technical information, illustrations and photographs are provided for information only, they are not contractual. Some may vary according to the tolerances accepted in the profession and the applicable standards. All instructions for use, disassembly and maintenance are recommendations only. These could also vary depending on product usage conditions, its installation environment and purchaser requirements – of which the purchaser alone is responsible for their definition.