

Ball valves

Model 50252 3-way ball valve with flanges and L-shaped bore (58229) and electric actuator IP66 (50840)



Specifications

⇒ Valve

Dimensions: DN15 to DN80 (1/2" to 3")

Connection: with flanges

Pressure: PN depending on flange dimensions

Operating Temperature: -29°C to +175°C

Material: 316 or CF8M stainless steel

(for the stainless steel parts that can come into contact with the transported fluid)

⇒ Electric actuator

Operating temperature: -10°C to +55°C

Plastic housing IP66

Visual position indicator

Self-regulating anti-condensation heater

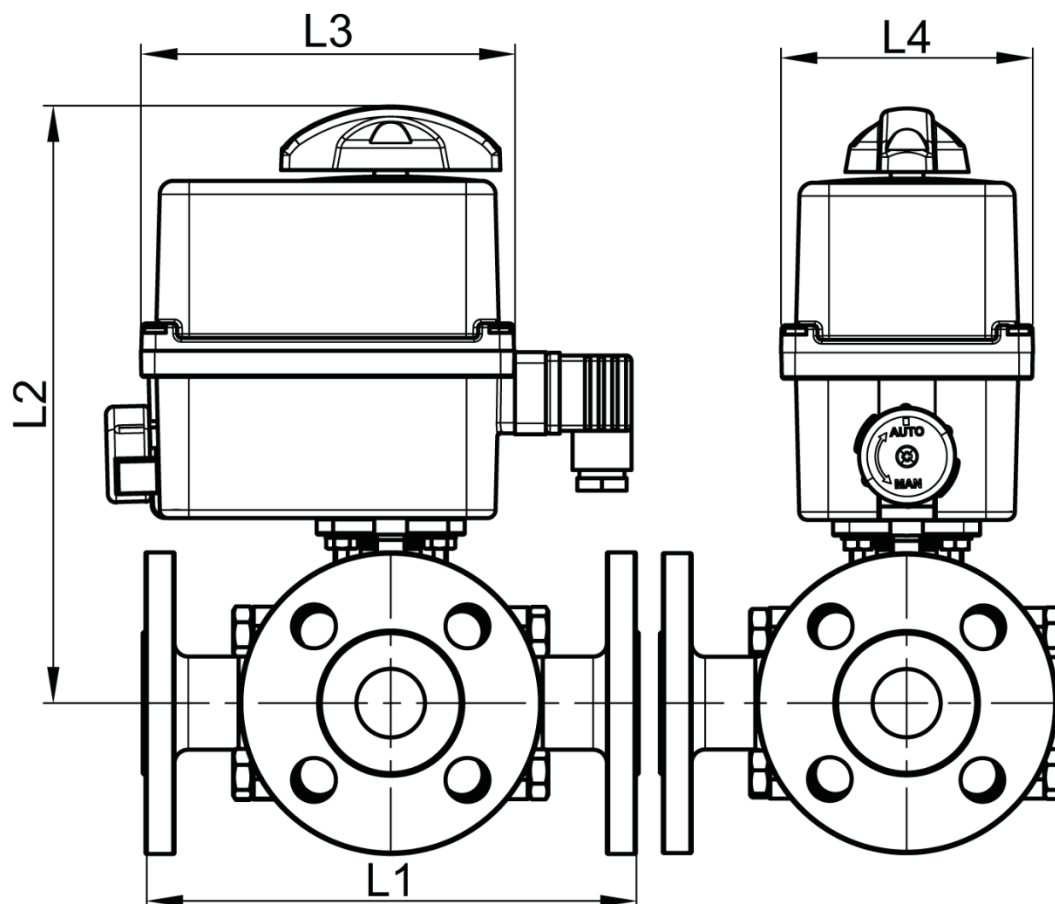

DN (mm)	NB (inches)	L1 (mm)	L2 (mm)	L3 (mm)	L4 (mm)	Opening/ closing time (90°) (s)	Weight (kg)	Part No. 100-230V AC and 100-350V DC	Opening/ closing time (90°) (s)	Part No. 15-30V AC and 12-48V DC
15	1/2"	150	205	136	92	12	7.30	450252-15A	12	450252-15B
20	3/4"	165	209	136	92	12	8.30	450252-20A	12	450252-20B
25	1"	181	220	136	92	26	9.80	450252-25A1	12	450252-25B1
25	1"	181	244	151	128	7	10.90	450252-25A2	7	450252-25B2
32	1 1/4"	190	224	136	92	26	11.80	450252-32A1	24	450252-32B1
32	1 1/4"	190	248	151	128	7	12.90	450252-32A2	7	450252-32B2
40	1 1/2"	212	261	151	128	12	15.30	450252-40A	12	450252-40B
50	2"	230	268	151	128	23	24.30	450252-50A	22	450252-50B
65	2 1/2"	290	283	151	128	23	33.60	450252-65A	22	450252-65B

Electric actuator with plastic housing with IP66 protection rating.
 Visual position indicator. Manual override control with safe clutch disengagement.
 Configurable limit switches. Torque limiting device. Anti-condensation heater.
 Actuator operating temperature: -10°C to +55°C.
 Duty cycle: 50%. Number of starts per hour: 150.
 Actuator sized for a valve $\Delta P = \max$. 16 bar. For $\Delta P > 16$ bar, please contact us.
 Standard operation: Opening/closing at 0/90°.

Béné Inox – 11 chemin de la Pierre Blanche – 69800 SAINT-PRIEST – S.A.S with 240 000 € share capital – SIREN N° 311 810 287
 Tel. N°: +33 (0)4 78 90 48 22 – Fax N°: +33 (0)4 78 90 69 59 – www.bene-inox.com – bene@bene-inox.com

Technical information, illustrations and photographs are provided for information only, they are not contractual. Some may vary according to the tolerances accepted in the profession and the applicable standards. All instructions for use, disassembly and maintenance are recommendations only. These could also vary depending on product usage conditions, its installation environment and purchaser requirements – of which the purchaser alone is responsible for their definition.

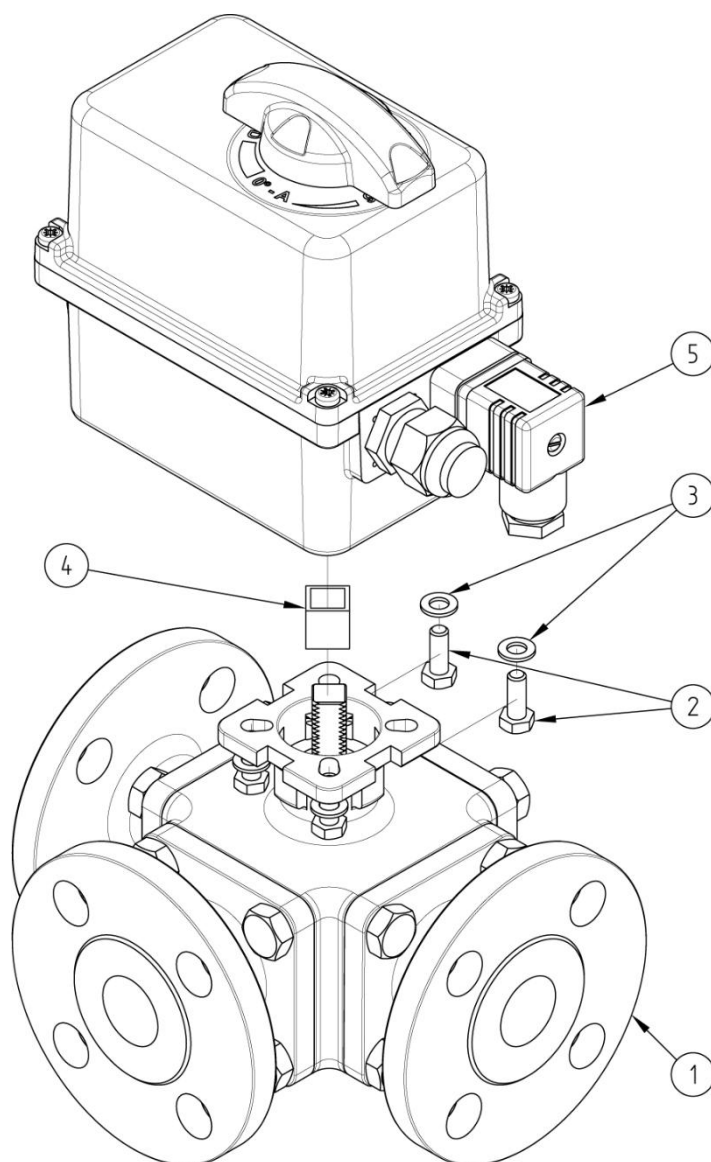

N°	Part Name	Material	Quantity
1	3-WAY VALVE WITH FLANGES (58229)	CF8M	1
2	FIXING BOLT	STAINLESS STEEL	4
3	WASHER	STAINLESS STEEL	4
4	COUPLING	STAINLESS STEEL	0 or 1
5	ELECTRIC ACTUATOR (50840)	PLASTIC	1

You can refer to the following product data sheets for more technical information:

- **58229** : 3-way valve with flanges - L-shaped bore
- **50840** : ¼ turn (90°) electric actuator - IP66

Béné Inox – 11 chemin de la Pierre Blanche – 69800 SAINT-PRIEST – S.A.S with 240 000 € share capital – SIREN N° 311 810 287
Tel. N°: +33 (0)4 78 90 48 22 – Fax N°: +33 (0)4 78 90 69 59 – www.bene-inox.com – bene@bene-inox.com

Technical information, illustrations and photographs are provided for information only, they are not contractual. Some may vary according to the tolerances accepted in the profession and the applicable standards. All instructions for use, disassembly and maintenance are recommendations only. These could also vary depending on product usage conditions, its installation environment and purchaser requirements – of which the purchaser alone is responsible for their definition.