

Ball valves

Model 50243 3-way ball valve with flanges and T-shaped bore (58227) and stainless steel pneumatic actuator (50802)



Specifications

⇒ Valve

Dimensions: DN15 to DN80 (1/2" to 3")

Connection: with flanges

Pressure: PN depending on flange dimensions

Operating Temperature: -29°C to +175°C

Material: 316 or CF8M stainless steel

(for the stainless steel parts that can come into contact with the transported fluid)

⇒ Pneumatic actuator

Air connection: 1/8" (VP50 to VP88) or 1/4" (VP100 to VP200)

Operating pressure: 6 to 8 bar

Operating temperature: -20°C to +85°C

Material: Stainless steel



Béné Inox – 11 chemin de la Pierre Blanche – 69800 SAINT-PRIEST – S.A.S with 240 000 € share capital – SIREN N° 311 810 287
Tel. N°: +33 (0)4 78 90 48 22 – Fax N°: +33 (0)4 78 90 69 59 – www.bene-inox.com – bene@bene-inox.com

Technical information, illustrations and photographs are provided for information only, they are not contractual. Some may vary according to the tolerances accepted in the profession and the applicable standards. All instructions for use, disassembly and maintenance are recommendations only. These could also vary depending on product usage conditions, its installation environment and purchaser requirements – of which the purchaser alone is responsible for their definition.

50243-A VI025

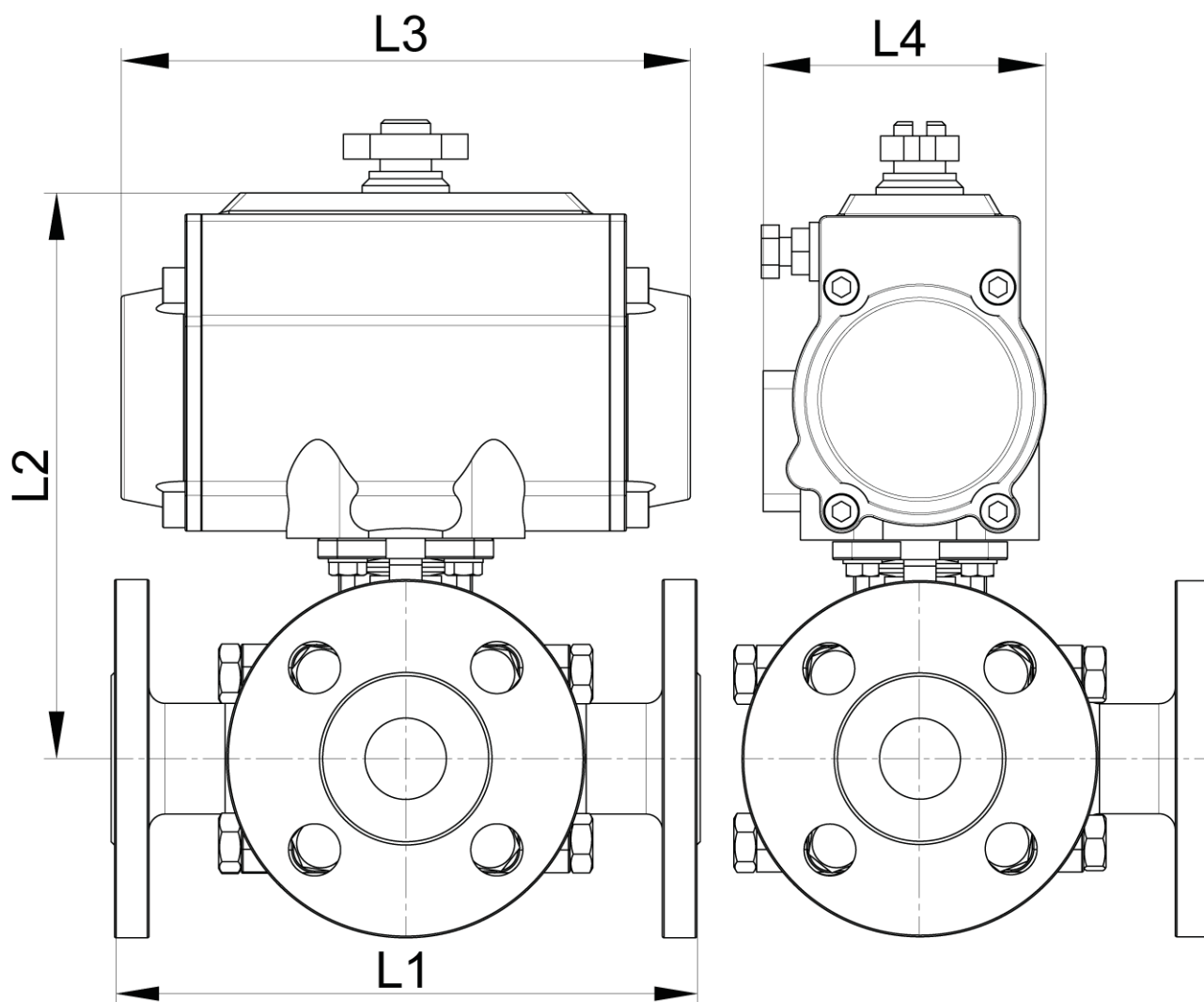

DN (mm)	NB (inches)	L1 (mm)	L2 (mm)	L3 (mm)	L4 (mm)	Weight (kg)	Spring return Part No.	Double-acting type Part No.
15	1/2"	150	139	141	71	8.70	450243-15SE	450243-15DE
20	3/4"	165	154	164	81	10.70	450243-20SE	-
20	3/4"	165	143	141	71	9.70	-	450243-20DE
25	1"	181	165	164	81	12.20	450243-25SE	450243-25DE
32	1"1/4	190	169	164	81	14.20	450243-32SE	450243-32DE
40	1"1/2	243	201	210	95	18.70	450243-40SE	450243-40DE
50	2"	230	208	210	95	27.70	450243-50SE	450243-50DE
65	2"1/2	290	251	275	123	43.20	450243-65SE	-
65	2"1/2	290	236	241	106	39.80	-	450243-65DE
80	3"	310	263	275	123	58.20	450243-80SE	450243-80DE

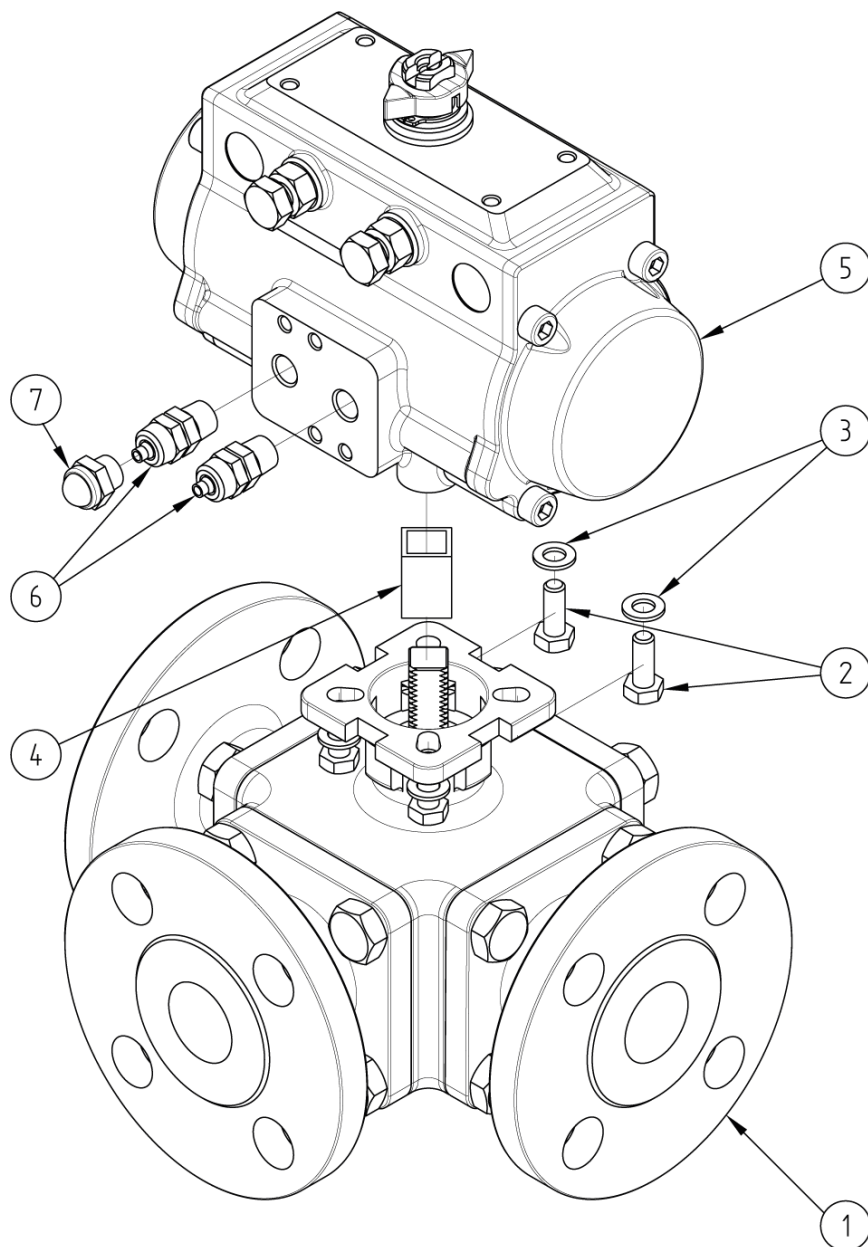

N°	Part Name	Material	Quantity
1	3-WAY VALVE WITH FLANGES (58227)	CF8M	1
2	FIXING BOLT	STAINLESS STEEL	4
3	WASHER	STAINLESS STEEL	4
4	COUPLING	STAINLESS STEEL	0 or 1
5	PNEUMATIC ACTUATOR (50802)	STAINLESS STEEL	1
6	CAPPED PNEUMATIC CONNECTOR	NICKEL-PLATED BRASS	1 (SE*) or 2 (DE**)
7	EXHAUST SILENCER	NICKEL-PLATED BRASS	1 (SE*)

*Spring return pneumatic actuator **Double-acting type pneumatic actuator

You can refer to the following product data sheets for more technical information:

- 58227: 3-way valve with flanges - T-shaped bore
- 50802SE: Spring return pneumatic actuator
- 50802DE: Double-acting type pneumatic actuator

Béné Inox – 11 chemin de la Pierre Blanche – 69800 SAINT-PRIEST – S.A.S with 240 000 € share capital – SIREN N° 311 810 287
Tel. N°: +33 (0)4 78 90 48 22 – Fax N°: +33 (0)4 78 90 69 59 – www.bene-inox.com – bene@bene-inox.com

Technical information, illustrations and photographs are provided for information only, they are not contractual. Some may vary according to the tolerances accepted in the profession and the applicable standards. All instructions for use, disassembly and maintenance are recommendations only. These could also vary depending on product usage conditions, its installation environment and purchaser requirements – of which the purchaser alone is responsible for their definition.