

# Ball valves

**Model 50229** 3-way F/F/F ball valve with T-shaped bore (58217) and electric actuator IP68 (50844)



## Specifications

### ⇒ Valve

**Dimensions:** DN20 to DN50 (3/4" to 2")

**Connection:** BSP female thread

**Pressure:** PN63 (1000 lbs)

**Operating temperature:** -29°C to +175°C

**Material:** 316 or CF8M stainless steel  
(for the stainless steel parts that can come into contact with the transported fluid)

### ⇒ Electric actuator

**Operating temperature:** -20°C to +70°C

Aluminium housing and plastic cap IP68

Visual position indicator

Self-regulating anti-condensation heater

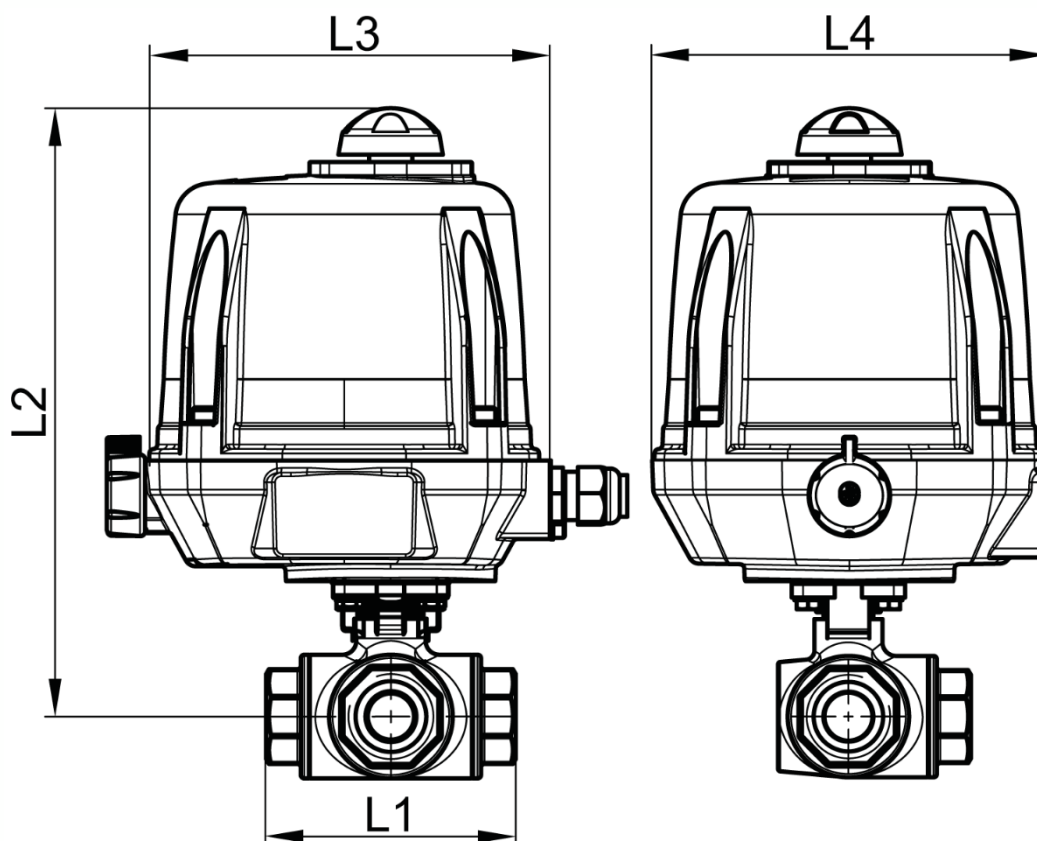

DN (mm)	NB (inches)	L1 (mm)	L2 (mm)	L3 (mm)	L4 (mm)	Opening/ closing time (90°) (s)	Weight (kg)	Part No. 100-230V AC and 100-350V DC
20	3/4"	90	250	192	170	7	4.40	450229-20A
25	1"	108	261	192	170	7	4.90	450229-25A
32	1"1/4	124	264	192	170	7	5.80	450229-32A
40	1"1/2	135	275	192	170	15	6.90	450229-40A
50	2"	164	284	192	170	15	9.80	450229-50A

DN (mm)	NB (inches)	Opening/ closing time (90°) (s)	Part No. 15-30V AC and 12-48V DC	Opening/ closing time (90°) (s)	Part No. 400V TRI 50/60 Hz
20	3/4"	7	450229-20B	10	450229-20C
25	1"	7	450229-25B	10	450229-25C
32	1"1/4	7	450229-32B	10	450229-32C
40	1"1/2	15	450229-40B	10	450229-40C
50	2"	15	450229-50B	10	450229-50C

Electric actuator with aluminium housing and plastic cap with IP68 protection rating.  
 Visual position indicator. Manual override control with safe clutch disengagement.  
 Configurable limit switches. Torque limiting device. Anti-condensation heater.  
 Actuator operating temperature: -20°C to +70°C.  
 Duty cycle: 50%. Number of starts per hour: 150.  
 Actuator sized for a valve  $\Delta P = \max.$  16 bar. For  $\Delta P > 16$  bar, please contact us.  
 Standard operation: Opening/closing at 0/90°.

**Béné Inox** – 11 chemin de la Pierre Blanche – 69800 SAINT-PRIEST – S.A.S with 240 000 € share capital – SIREN N° 311 810 287  
 Tel. N°: +33 (0)4 78 90 48 22 – Fax N°: +33 (0)4 78 90 69 59 – [www.bene-inox.com](http://www.bene-inox.com) – [bene@bene-inox.com](mailto:bene@bene-inox.com)

Technical information, illustrations and photographs are provided for information only, they are not contractual. Some may vary according to the tolerances accepted in the profession and the applicable standards. All instructions for use, disassembly and maintenance are recommendations only. These could also vary depending on product usage conditions, its installation environment and purchaser requirements – of which the purchaser alone is responsible for their definition.

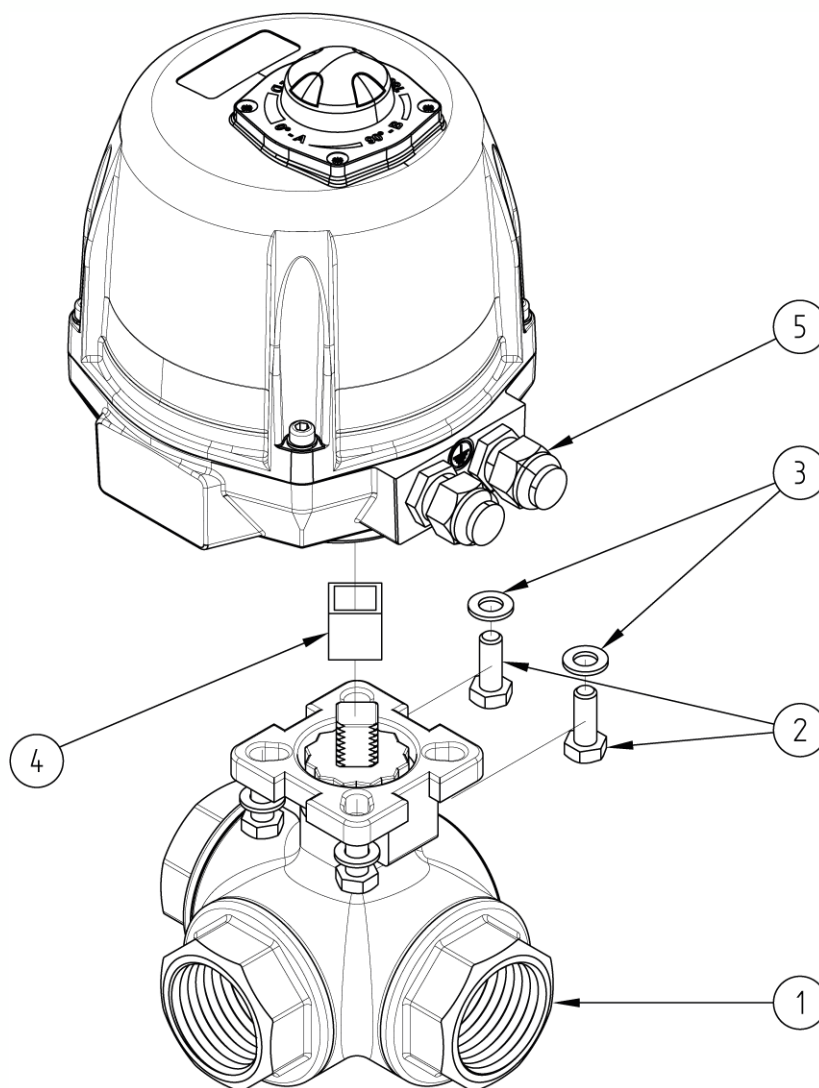

N°	Part Name	Material	Quantity
1	3-WAY VALVE (58217)	CF8M	1
2	FIXING BOLT	STAINLESS STEEL	4
3	WASHER	STAINLESS STEEL	4
4	COUPLING	STAINLESS STEEL	0 or 1
5	ELECTRIC ACTUATOR (50844)	ALUMINIUM/PLASTIC	1

You can refer to the following product data sheets for more technical information:

- **58217** : 3-way F/F/F valve - T-shaped bore
- **50844** : 1/4 turn (90°) electric actuator - IP68

**Béné Inox** – 11 chemin de la Pierre Blanche – 69800 SAINT-PRIEST – S.A.S with 240 000 € share capital – SIREN N° 311 810 287  
Tel. N°: +33 (0)4 78 90 48 22 – Fax N°: +33 (0)4 78 90 69 59 – [www.bene-inox.com](http://www.bene-inox.com) – [bene@bene-inox.com](mailto:bene@bene-inox.com)

Technical information, illustrations and photographs are provided for information only, they are not contractual. Some may vary according to the tolerances accepted in the profession and the applicable standards. All instructions for use, disassembly and maintenance are recommendations only. These could also vary depending on product usage conditions, its installation environment and purchaser requirements – of which the purchaser alone is responsible for their definition.