

# Ball valves

## Model 50217 3-way F/F/F ball valve with T-shaped bore (58217) and electric actuator IP65 (50835)



### Specifications

#### ⇒ Valve

**Dimensions:** DN8 to DN50 (1/4" to 2")

**Connection:** BSP female thread

**Pressure:** PN63 (1000 lbs)

**Operating temperature:** -29°C to +175°C

**Material:** 316 or CF8M stainless steel  
(for the stainless steel parts that can come into contact with the transported fluid)

#### ⇒ Electric actuator

**Operating temperature:** -10°C to +50°C

**Material:** Plastic

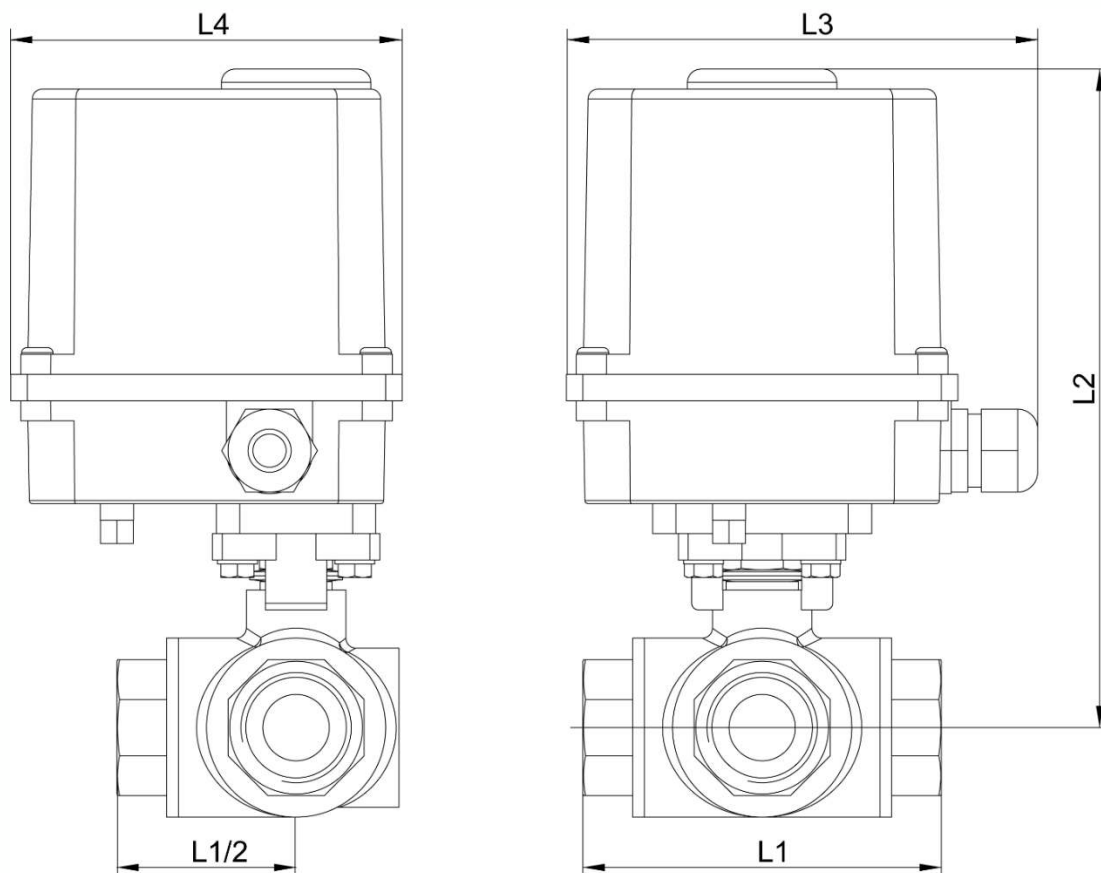

DN (mm)	NB (inches)	L1 (mm)	L2 (mm)	L3 (mm)	L4 (mm)	Opening/closing time (s)	Weight (kg)	Part No. 100-230V AC and 100-350V DC
8	1/4"	79	185	143	118	10	2.15	450217-8A
10	3/8"	79	185	143	118	10	2.15	450217-10A
15	1/2"	79	185	143	118	10	2.15	450217-15A
20	3/4"	90	192	143	118	10	2.15	450217-20A
25	1"	108	203	143	118	10	2.15	450217-25A
32	1 1/4"	124	206	143	118	10	4.10	450217-32A
40	1 1/2"	135	217	143	118	10	5.20	450217-40A
50	2"	164	250	204	165	8	10.70	450217-50A

DN (mm)	NB (inches)	Opening/closing time (s)	Part No. 24V 50Hz	Opening/closing time (s)	Part No. 24V DC
8	1/4"	15	450217-8B	16	450217-8C
10	3/8"	15	450217-10B	16	450217-10C
15	1/2"	15	450217-15B	16	450217-15C
20	3/4"	15	450217-20B	16	450217-20C
25	1"	15	450217-25B	16	450217-25C
32	1 1/4"	15	450217-32B	16	450217-32C
40	1 1/2"	15	450217-40B	16	450217-40C

**Béné Inox** – 11 chemin de la Pierre Blanche – 69800 SAINT-PRIEST – S.A.S with 240 000 € share capital – SIREN N° 311 810 287  
Tel. N°: +33 (0)4 78 90 48 22 – Fax N°: +33 (0)4 78 90 69 59 – [www.bene-inox.com](http://www.bene-inox.com) – [bene@bene-inox.com](mailto:bene@bene-inox.com)

Technical information, illustrations and photographs are provided for information only, they are not contractual. Some may vary according to the tolerances accepted in the profession and the applicable standards. All instructions for use, disassembly and maintenance are recommendations only. These could also vary depending on product usage conditions, its installation environment and purchaser requirements – of which the purchaser alone is responsible for their definition.

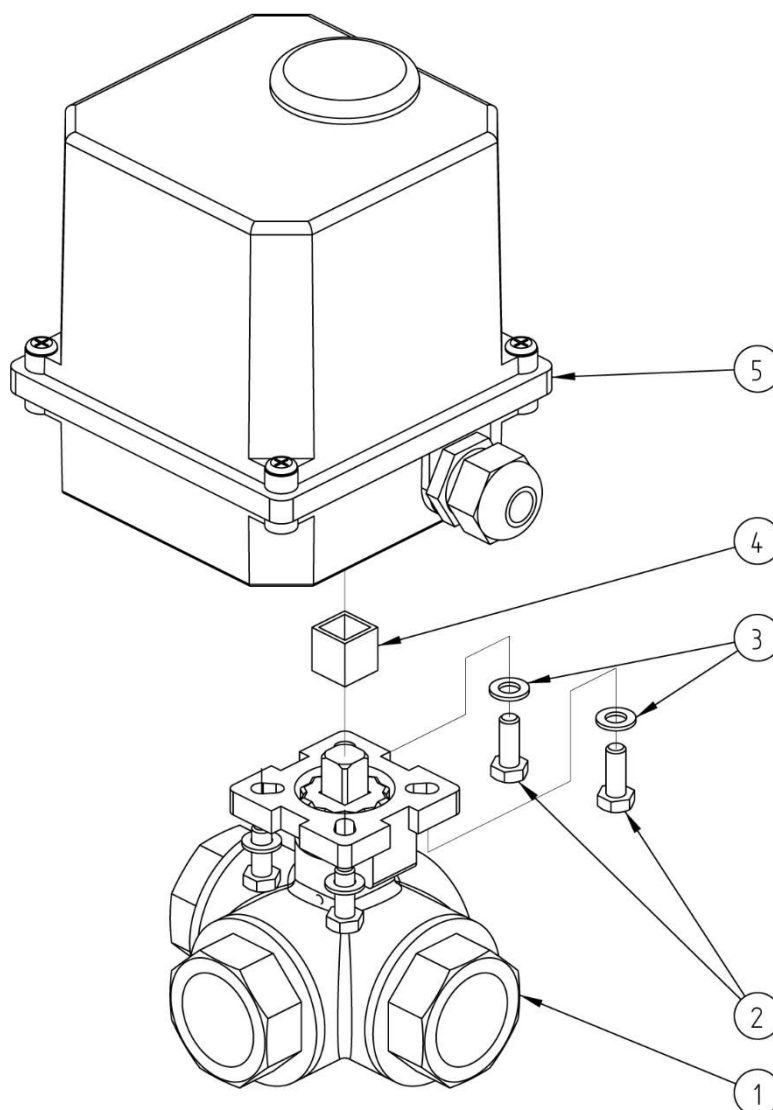

N°	Part Name	Material	Quantity
1	3-WAY VALVE (58217)	CF8M	1
2	FIXING BOLT	STAINLESS STEEL	4
3	WASHER	STAINLESS STEEL	4
4	COUPLING	STAINLESS STEEL	0 or 1
5	ELECTRIC ACTUATOR (50835)	PLASTIC	1

You can refer to the following product data sheets for more technical information:

- **58217** : 3-way valve - T-shaped bore
- **50835** : Electric actuator