

Ball valves

Model 50213 3-way F/F/F ball valve with T-shaped bore
(58217)
and stainless steel pneumatic actuator
(50802)



Specifications

⇒ **Valve**

Dimensions: DN8 to DN50 (1/4" to 2")

Connection: BSP female thread

Pressure: PN63 (1000 lbs)

Operating temperature: -29°C to +175°C

Material: 316 or CF8M stainless steel

(for the stainless steel parts that can come into contact with the transported fluid)

⇒ **Pneumatic actuator**

Air connection: 1/8" (VP50 to VP88) or

1/4" (VP100 to VP200)

Operating pressure: 6 to 8 bar

Operating temperature: -20°C to +85°C

Material: Stainless steel



Béné Inox – 11 chemin de la Pierre Blanche – 69800 SAINT-PRIEST – S.A.S with 240 000 € share capital – SIREN N° 311 810 287
Tel. N°: +33 (0)4 78 90 48 22 – Fax N°: +33 (0)4 78 90 69 59 – www.bene-inox.com – bene@bene-inox.com

Technical information, illustrations and photographs are provided for information only, they are not contractual. Some may vary according to the tolerances accepted in the profession and the applicable standards. All instructions for use, disassembly and maintenance are recommendations only. These could also vary depending on product usage conditions, its installation environment and purchaser requirements – of which the purchaser alone is responsible for their definition.

50213-A V1025

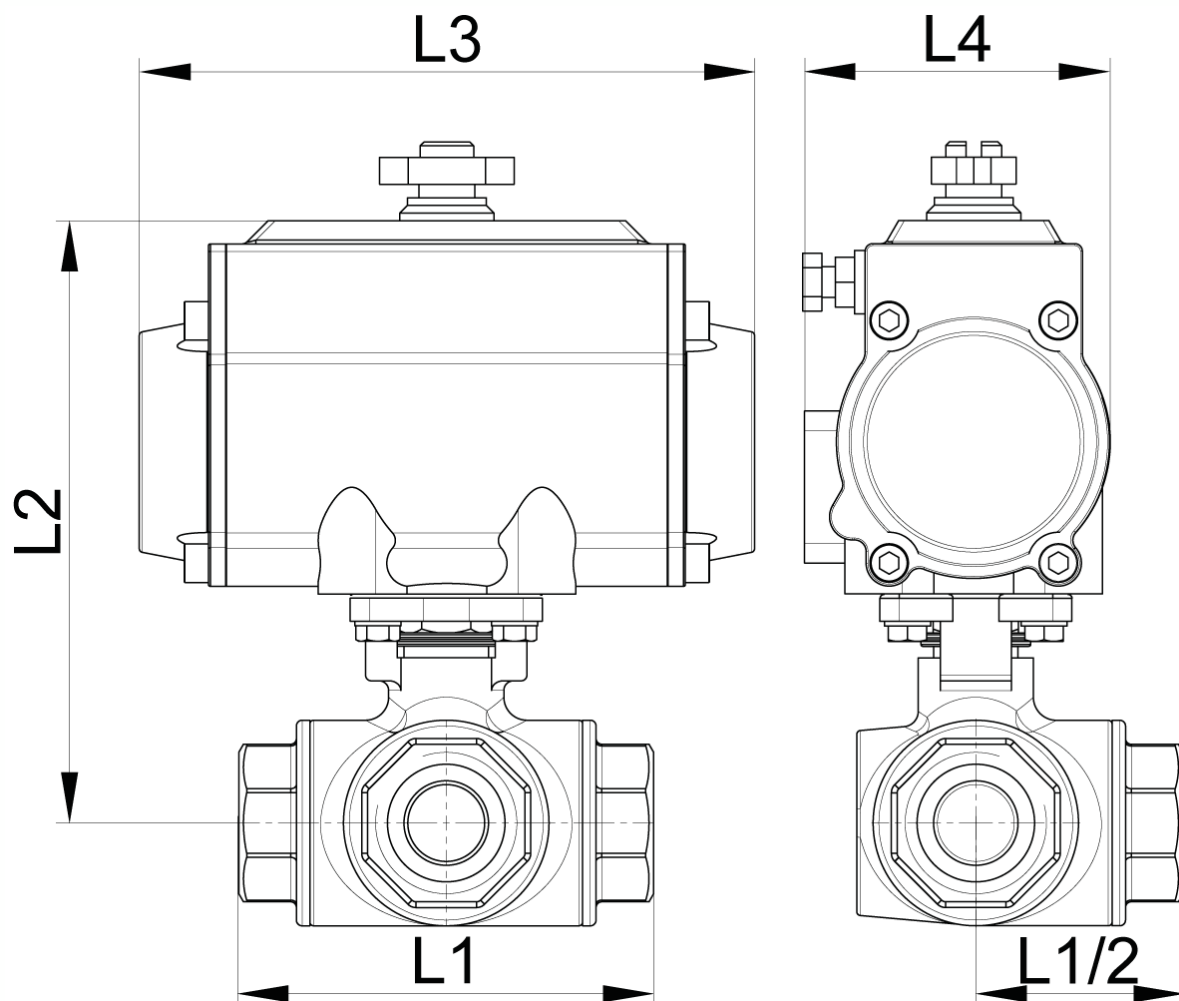

DN (mm)	NB (inches)	L1 (mm)	L2 (mm)	L3 (mm)	L4 (mm)	Weight (kg)	Spring return Part No.	Double- acting type Part No.
8	1/4"	79	128	141	71	2.95	450213-8SE	450213-8DE
10	3/8"	79	128	141	71	2.95	450213-10SE	450213-10DE
15	1/2"	79	128	141	71	2.95	450213-15SE	450213-15DE
20	3/4"	90	146	164	81	4.50	450213-20SE	-
20	3/4"	90	146	141	71	4.50	-	450213-20DE
25	1"	100	147	164	81	4.87	450213-25SE	450213-25DE
32	1"1/4	124	160	164	81	5.90	450213-32SE	450213-32DE
40	1"1/2	135	190	210	95	9.10	450213-40SE	450213-40DE
50	2"	164	199	210	95	12.00	450213-50SE	450213-50DE

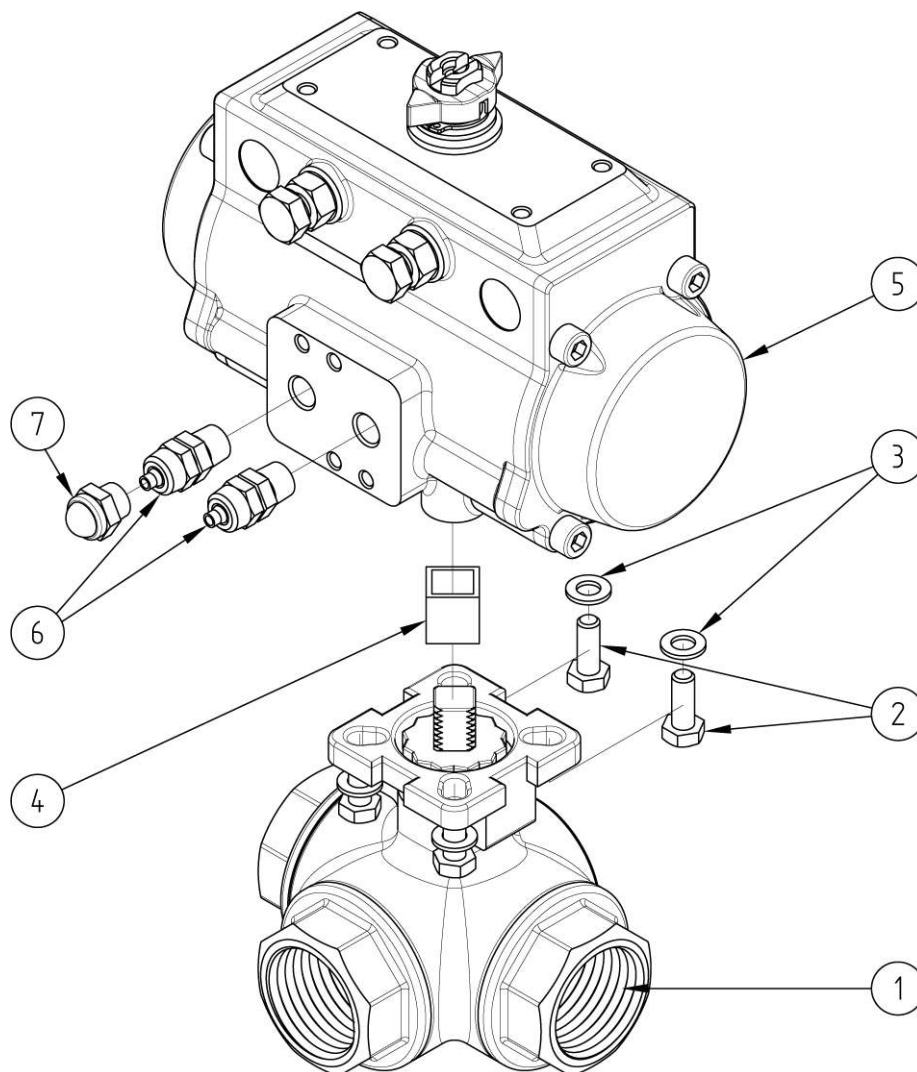

N°	Part Name	Material	Quantity
1	3-WAY VALVE (58217)	CF8M	1
2	FIXING BOLT	STAINLESS STEEL	4
3	WASHER	STAINLESS STEEL	4
4	COUPLING	STAINLESS STEEL	0 or 1
5	PNEUMATIC ACTUATOR (50802)	STAINLESS STEEL	1
6	CAPPED PNEUMATIC CONNECTOR	NICKEL-PLATED BRASS	1 (SE*) or 2 (DE**)
7	EXHAUST SILENCER	NICKEL-PLATED BRASS	1 (SE*)

*Spring return pneumatic actuator **Double-acting type pneumatic actuator

You can refer to the following product data sheets for more technical information:

- **58217** : 3-way valve - T-shaped bore
- **50802SE** : Spring return pneumatic actuator
- **50802DE** : Double-acting type pneumatic actuator

Béné Inox – 11 chemin de la Pierre Blanche – 69800 SAINT-PRIEST – S.A.S with 240 000 € share capital – SIREN N° 311 810 287
Tel. N°: +33 (0)4 78 90 48 22 – Fax N°: +33 (0)4 78 90 69 59 – www.bene-inox.com – bene@bene-inox.com

Technical information, illustrations and photographs are provided for information only, they are not contractual. Some may vary according to the tolerances accepted in the profession and the applicable standards. All instructions for use, disassembly and maintenance are recommendations only. These could also vary depending on product usage conditions, its installation environment and purchaser requirements – of which the purchaser alone is responsible for their definition.