

Ball valves

Model 50183 3-part ball valve for socket welding (SW) (58471) with fail-safe ATEX electric actuator IP68 (50849)



Specifications

⇒ Valve

Dimensions: DN20 to DN50 (3/4" to 2")

Connection: to be welded (socket welding)

Pressure: PN100 (1500 lbs)

Operating temperature: -29°C to +200°C

Material: 316 or CF8M stainless steel
(for the stainless steel parts that can come into contact with the transported fluid)

⇒ Electric actuator

Operating temperature: -10°C to +40°C

Aluminium housing and cap IP68

Visual position indicator

Anti-condensation heater

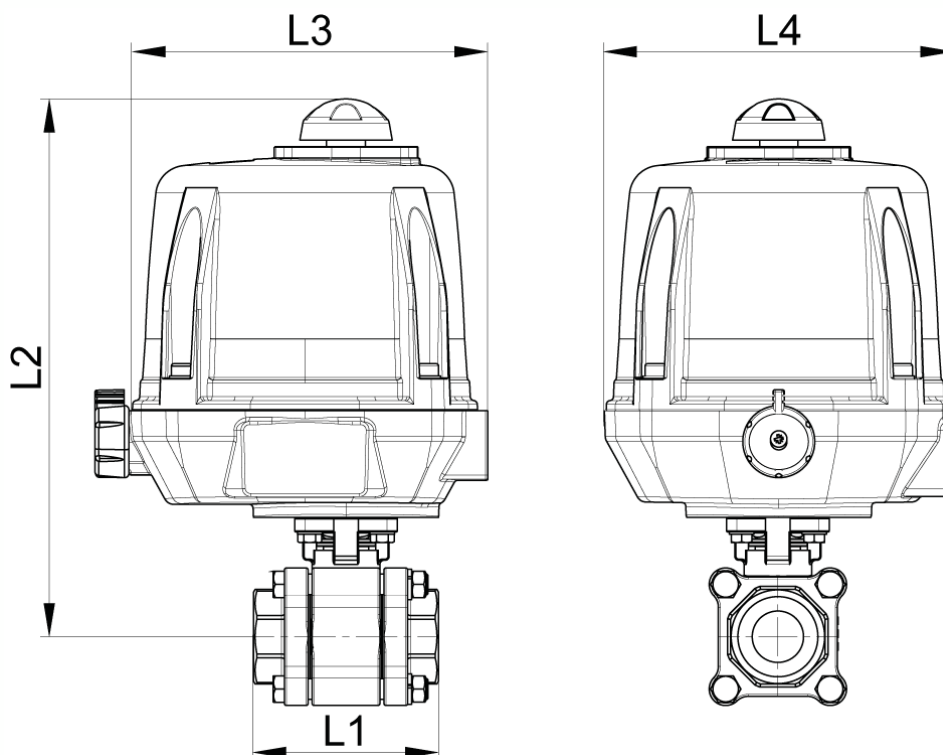

DN (mm)	NB (inches)	L1 (mm)	L2 (mm)	L3 (mm)	L4 (mm)	Opening/ closing time (90°) (s)	Weight (kg)	Part No. 100-230V AC and 100-350V DC	Part No. 15-30V AC and 12-48V DC
20	3/4"	81	244	192	170	7	5.42	450183-20A	450183-20B
25	1"	90	251	192	170	7	5.87	450183-25A	450183-25B
32	1"1/4	110	259	192	170	7	6.50	450183-32A	450183-32B
40	1"1/2	122	264	192	170	15	7.40	450183-40A	450183-40B
50	2"	140	276	192	170	15	8.90	450183-50A	450183-50B

ATEX 1/4 turn (90°) electric actuator with aluminium housing and cap IP68.

Visual position indicator. Manual override control with safe clutch disengagement.

Configurable limit switches. Torque limiting device. Anti-condensation heater.

Actuator operating temperature: -10°C to +40°C.

Duty cycle: 50%. Number of starts per hour: 150.

Actuator sized for a valve $\Delta P = \max. 16 \text{ bar}$. For $\Delta P > 16 \text{ bar}$, please contact us.

Fail-safe version: The internal fail-safe backup unit (circuit board + battery) makes sure that the valve returns to the closed position if there is a power cut.

You must order earthing braids separately.

Cable glands are not supplied.

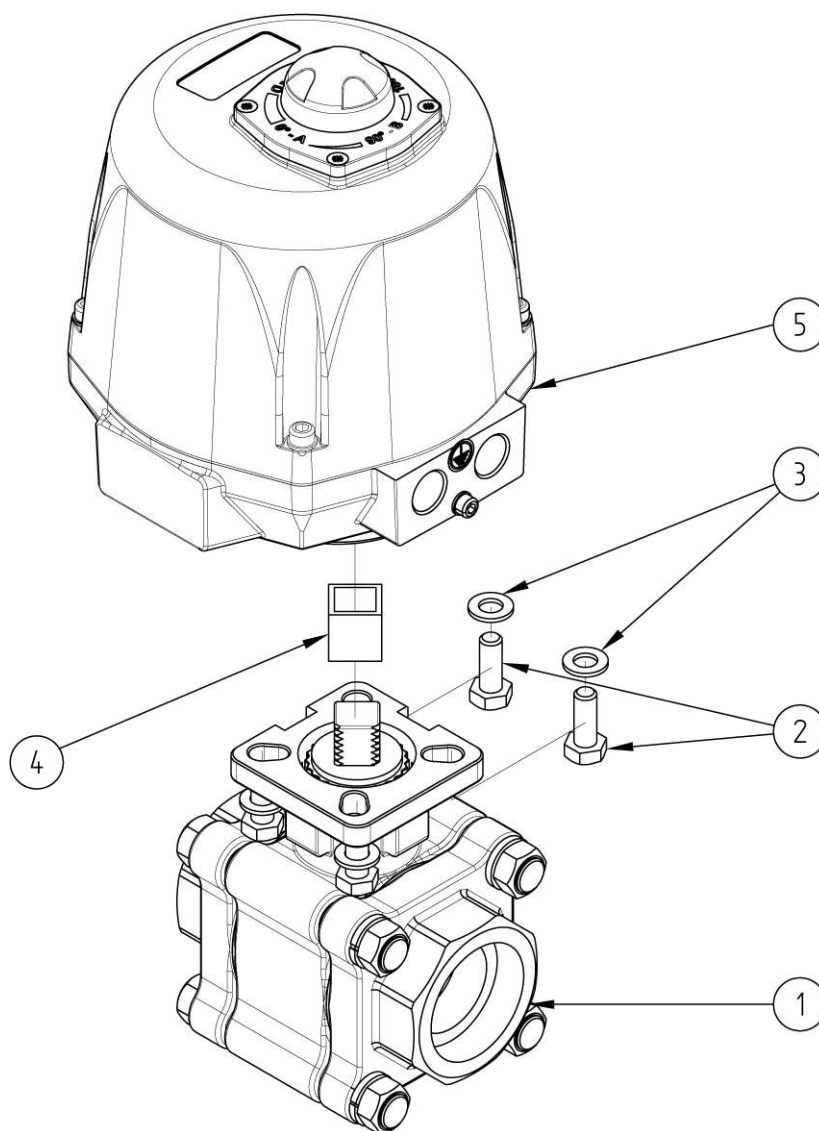

N°	Part Name	Material	Quantity
1	3-PART VALVE (58471)	CF8M	1
2	FIXING BOLT	STAINLESS STEEL	4
3	WASHER	STAINLESS STEEL	4
4	COUPLING	STAINLESS STEEL	0 or 1
5	ELECTRIC ACTUATOR (50849)	ALUMINIUM	1

You can refer to the following product data sheets for more technical information:

- **58471** : 3-part valve to be socket welded (SW)
- **50849** : Fail-safe ATEX 1/4 turn (90°) electric actuator - IP68