

Ball valves

Model 50179 3-part F/F ball valve (58463) with ATEX electric actuator IP68 (50848)



Specifications

⇒ Valve

Dimensions: DN20 to DN50 (3/4" to 2")

Connection: BSP female thread

Pressure: PN100 (1500 lbs)

Operating temperature: -29°C to +200°C

Material: 316 or CF8M stainless steel
(for the stainless steel parts that can come into contact with the transported fluid)

⇒ Electric actuator

Operating temperature: -20°C to +70°C

Aluminium housing and cap IP68

Visual position indicator

Anti-condensation heater

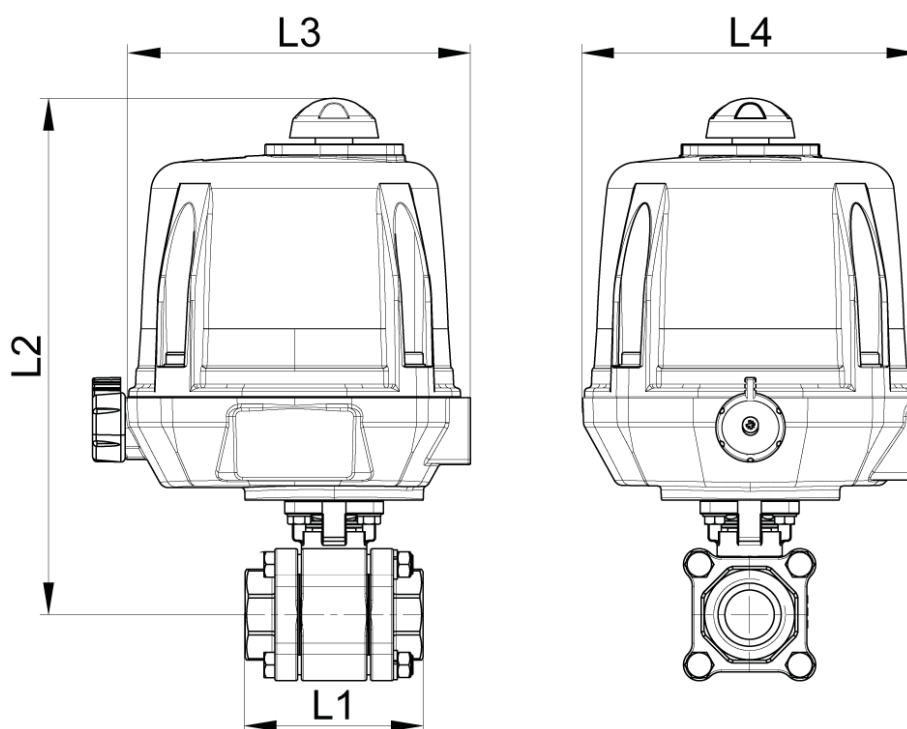

DN (mm)	NB (inches)	L1 (mm)	L2 (mm)	L3 (mm)	L4 (mm)	Opening/ closing time (90°) (s)	Weight (kg)	Part No. 100-230V AC and 100-350V DC
20	3/4"	81	244	192	170	7	5.22	450179-20A
25	1"	90	251	192	170	7	5.67	450179-25A
32	1"1/4	110	259	192	170	15	6.30	450179-32A
40	1"1/2	122	264	192	170	20	7.20	450179-40A
50	2"	140	276	192	170	20	8.70	450179-50A

DN (mm)	NB (inches)	Opening/ closing time (90°) (s)	Part No. 15-30V AC and 12-48V DC	Opening/ closing time (90°) (s)	Part No. 400V TRI 50/60 Hz
20	3/4"	7	450179-20B	10	450179-20C
25	1"	7	450179-25B	10	450179-25C
32	1"1/4	15	450179-32B	10	450179-32C
40	1"1/2	20	450179-40B	15	450179-40C
50	2"	20	450179-50B	15	450179-50C

ATEX 1/4 turn (90°) electric actuator with aluminium housing and cap IP68.
 Visual position indicator. Manual override control with safe clutch disengagement.
 Configurable limit switches. Torque limiting device. Anti-condensation heater.
 Actuator operating temperature: -20°C to +70°C.
 Duty cycle: 50%. Number of starts per hour: 150.
 Actuator sized for a valve $\Delta P = \max$. 16 bar. For $\Delta P > 16$ bar, please contact us.
 Standard operation: Opening/closing at 0/90°.

You must order earthing braids separately.
 Cable glands are not supplied.

Béné inox – 11 chemin de la Pierre Blanche – 69800 SAINT-PRIEST – S.A.S with 240 000 € share capital – SIREN N° 311 810 287
 Tel. N°: +33 (0)4 78 90 48 22 – Fax N°: +33 (0)4 78 90 69 59 – www.bene-inox.com – bene@bene-inox.com

Technical information, illustrations and photographs are provided for information only, they are not contractual. Some may vary according to the tolerances accepted in the profession and the applicable standards. All instructions for use, disassembly and maintenance are recommendations only. These could also vary depending on product usage conditions, its installation environment and purchaser requirements – of which the purchaser alone is responsible for their definition.

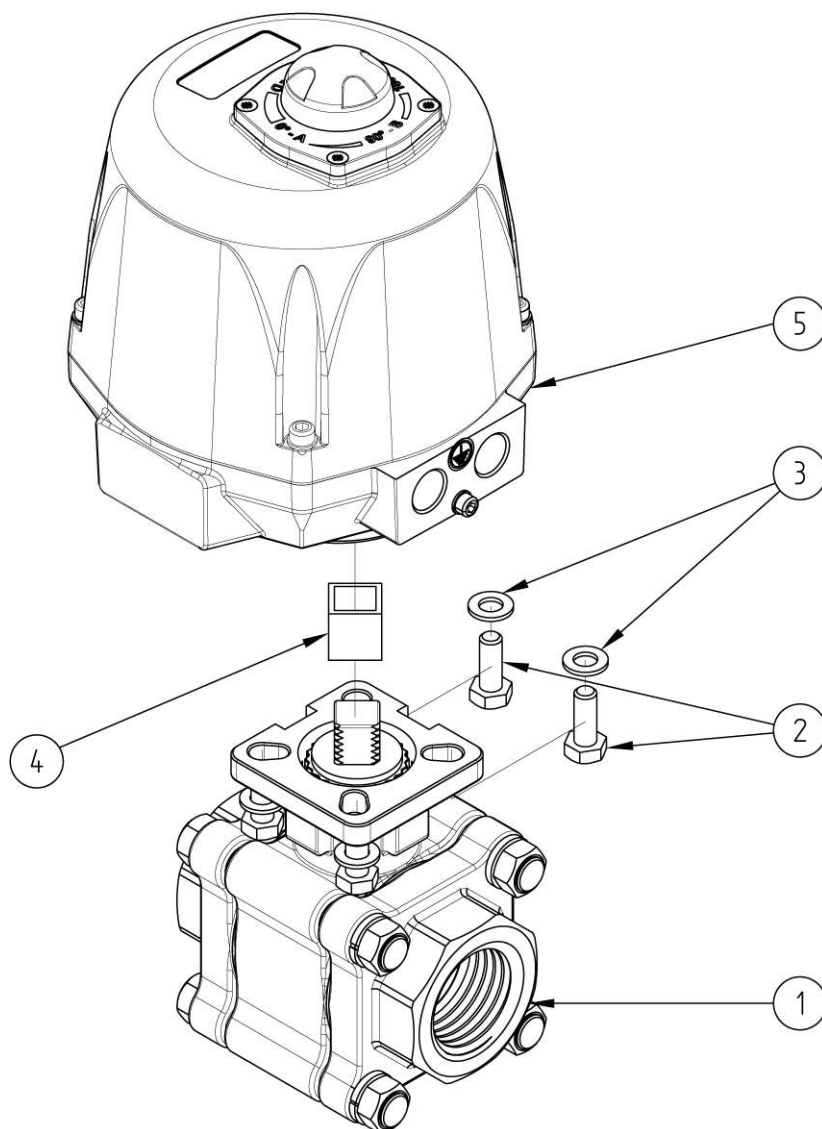

N°	Part Name	Material	Quantity
1	3-PART VALVE (58463)	CF8M	1
2	FIXING BOLT	STAINLESS STEEL	4
3	WASHER	STAINLESS STEEL	4
4	COUPLING	STAINLESS STEEL	0 or 1
5	ELECTRIC ACTUATOR (50848)	ALUMINIUM	1

You can refer to the following product data sheets for more technical information:

- **58463** : 3-part female/female valve
- **50848** : ATEX 1/4 turn (90°) electric actuator - IP68

Béné Inox – 11 chemin de la Pierre Blanche – 69800 SAINT-PRIEST – S.A.S with 240 000 € share capital – SIREN N° 311 810 287
Tel. N°: +33 (0)4 78 90 48 22 – Fax N°: +33 (0)4 78 90 69 59 – www.bene-inox.com – bene@bene-inox.com

Technical information, illustrations and photographs are provided for information only, they are not contractual. Some may vary according to the tolerances accepted in the profession and the applicable standards. All instructions for use, disassembly and maintenance are recommendations only. These could also vary depending on product usage conditions, its installation environment and purchaser requirements – of which the purchaser alone is responsible for their definition.