

# Ball valves

## Model 50142 3-part ball valve for butt welding (BW) (58472) with aluminium pneumatic actuator (50800)



### Specifications

#### ⇒ Valve

**Dimensions:** DN8 to DN50 (1/4" to 2")

**Connection:** to be welded (butt welding)

**Pressure:** PN100 (1500 lbs)

**Operating temperature:** -29°C to +200°C

**Material:** 316 or CF8M stainless steel  
(for the stainless steel parts that can come into contact with the transported fluid)

#### ⇒ Pneumatic actuator

**Air connection:** 1/8" (VP50 to VP88)

**Operating pressure:** 6 to 8 bar

**Operating temperature:** -20°C to +80°C

**Material:** Aluminium

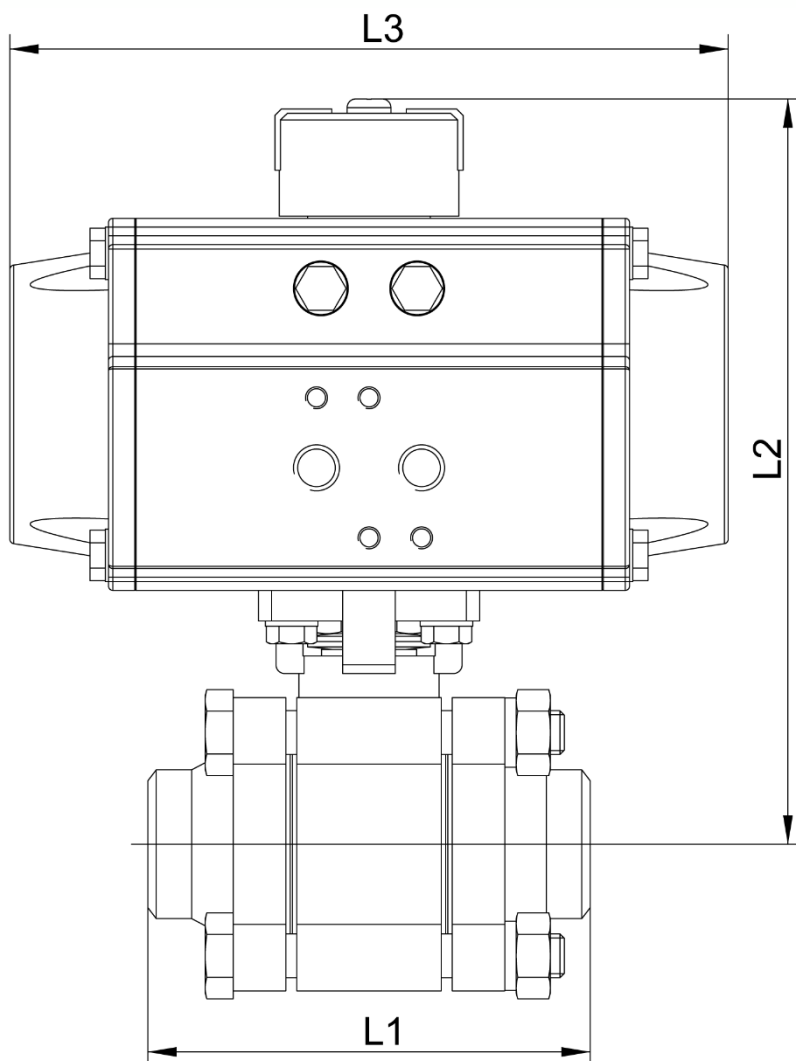
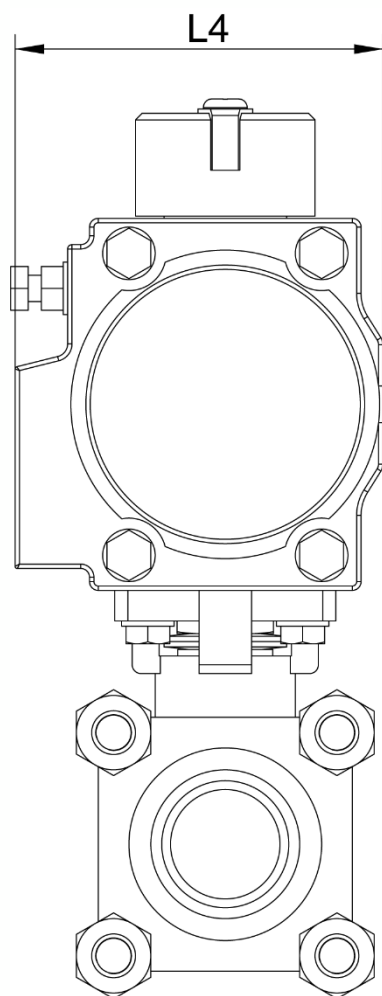

DN (mm)	NB (inches)	L1 (mm)	L2 (mm)	L3 (mm)	L4 (mm)	Weight (kg)	Spring return Part No.	Double- acting type Part No.
8	1/4"	70	115	148	72	1.17	450142-8SE	450142-8DE
10	3/8"	70	115	148	72	1.24	450142-10SE	450142-10DE
15	1/2"	75	115	148	72	1.36	450142-15SE	450142-15DE
20	3/4"	92	128	164	84	1.84	450142-20SE	-
20	3/4"	92	115	148	72	1.84	-	450142-20DE
25	1"	100	135	164	84	2.74	450142-25SE	450142-25DE
32	1"1/4	110	143	164	84	4.00	450142-32SE	450142-32DE
40	1"1/2	125	166	208	96	5.75	450142-40SE	450142-40DE
50	2"	150	178	208	96	8.90	450142-50SE	450142-50DE

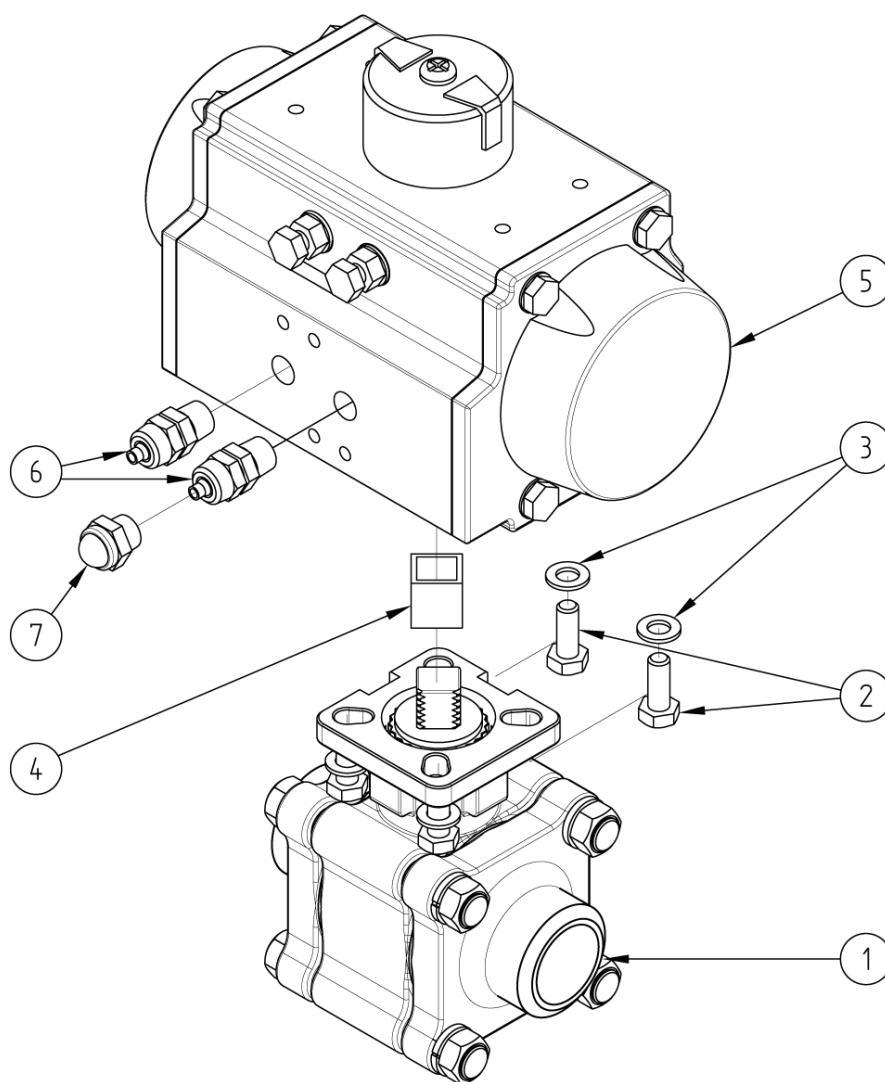

N°	Part Name	Material	Quantity
1	3-PART VALVE (58472)	CF8M	1
2	FIXING BOLT	STAINLESS STEEL	4
3	WASHER	STAINLESS STEEL	4
4	COUPLING	STAINLESS STEEL	0 or 1
5	PNEUMATIC ACTUATOR (50800)	ALUMINIUM	1
6	CAPPED PNEUMATIC CONNECTOR	NICKEL-PLATED BRASS	1 (SE*) or 2 (DE**)
7	EXHAUST SILENCER	NICKEL-PLATED BRASS	1 (SE*)

\*Spring return pneumatic actuator \*\*Double-acting type pneumatic actuator

You can refer to the following product data sheets for more technical information:

- **58472** : 3-part valve to be welded (butt welding)
- **50800SE** : Spring return pneumatic actuator
- **50800DE** : Double-acting type pneumatic actuator

**Béné Inox** – 11 chemin de la Pierre Blanche – 69800 SAINT-PRIEST – S.A.S with 240 000 € share capital – SIREN N° 311 810 287  
Tel. N°: +33 (0)4 78 90 48 22 – Fax N°: +33 (0)4 78 90 69 59 – [www.bene-inox.com](http://www.bene-inox.com) – [bene@bene-inox.com](mailto:bene@bene-inox.com)

Technical information, illustrations and photographs are provided for information only, they are not contractual. Some may vary according to the tolerances accepted in the profession and the applicable standards. All instructions for use, disassembly and maintenance are recommendations only. These could also vary depending on product usage conditions, its installation environment and purchaser requirements – of which the purchaser alone is responsible for their definition.